

HD Digital Receiver

User's Manual

HDR-1001S

HUMAX

For Your Safety

Safety Instructions

1. POWER SUPPLY

- Operate this product only from the type of power supply shown on the marking label. If you do not know the type of power supplied to your home, contact your local power company.
- Disconnect the power supply before you start any maintenance or installation procedures.

2. OVERLOADING

- Make sure that the wall outlet, extension cord and adapter have a sufficient power rating for the appliance. If not, this can cause an electric fire shock.

3. LIQUID

- Do not expose this product to liquids. Do not put objects filled with liquid on the product.

4. CLEANING

- Disconnect the product from the wall outlet before you clean it.
- Use a moist cloth to clean the product. Do not use solvents. Wipe the surface gently with a soft cloth as it may get scratched.

5. VENTILATION

- Make sure that the slots on top of the product are not blocked. It is necessary to have a sufficient airflow into the unit.
- Do not put electronic equipment on the product.
- Do not put objects on the product. This will block the ventilation or cause damage to the surface.

6. ATTACHMENTS

- Do not use any unsupported attachments as these may be hazardous or cause damage to the product.

7. LIGHTNING, STORM OR NOT IN USE

- Unplug the product from the wall outlet and disconnect the antenna during a thunderstorm or when left unattended and unused for long

periods of time. This will prevent damage to the unit due to lightning and power-surges.

8. EXTRANEIOUS OBJECTS

- Do not insert anything through the openings in the unit, where they can touch dangerous voltage points or damage parts.

9. REPLACEMENT OF PARTS

- When replacement of parts is required, be sure the service technician uses replacement parts specified by the manufacturer or those that have the same characteristics as the original part. Unauthorised substitution may result in additional damage to the unit.

10. CONNECTION TO THE SATELLITE DISH LNB/ CABLE TV SIGNAL/AERIAL

- Disconnect the power supply before you connect or disconnect the cable from the satellite dish/cable TV signal/aerial. If not, this can cause damage to the LNB/cable TV line/aerial.

11. CONNECTION TO THE TV

- Disconnect the power supply before you connect or disconnect the cable from the TV. If not, this can cause damage to the TV.

12. EARTHING (satellite only)

- Earth the LNB cable to the system earth for the satellite dish.

13. LOCATION

- Place the product indoors to avoid exposure to lightning, rain or sun. Do not place it near a radiator or heat register.
- Keep at least 10 cm clearance from any other appliances susceptible to electromagnetic influences such as a TV or a VCR.
- If you place the product on a rack or a bookcase, make sure that there is adequate ventilation and that you have followed the manufacturer's instructions for mounting.
- Do not place the product on an unstable surface where it can fall. A falling product

can cause serious injury to a personnel and serious damage to the appliance.

Cautions and Warnings

1. To avoid damage of the power cord or plug

- Do not modify or process the power cord or plug arbitrarily.
- Do not bend or twist the power cord.
- Make sure to disconnect the power cord while you hold the plug.
- Keep heating appliances as far as possible from the power cord to prevent the cover vinyl from melting.
- The mains plug, as a disconnection device, shall remain readily accessible by the user.

2. To avoid electrical shock

- Do not open the main body.
- Do not insert metal or inflammable objects inside the product.
- Do not touch the power plug with wet hands.
- Disconnect the power cord in case of lightning.
- Unplug the power cable before you install the antenna cable.

3. To avoid damage of product

- Do not use the product when it is out of order. If you continue to use the product when defective, this may cause serious damage. Make sure to contact the customer service centre if the product is out of order.
- Do not insert metal or alien substance into the slots for the modules or Smartcards. It may cause damage to the product and reduce its life span.

4. To avoid damage of the hard disk drive (PVR only)

- Do not move the product or turn the power off suddenly while the hard disk drive is running.
- The company shall not be liable for any corruption of data on the hard disk drive caused by carelessness or misuse of the user.

Contents

For Your Safety	3
Contents & Accessories.....	4
Contents	
Accessories	
Quick Start Guide	5
Front & Rear	
Remote Control	
Connections	
Wizard	
Managing Channels.....	12
Program Information	
Channel List	
Live TV.....	16
Now & Next	
Channel Guide	
TV Apps & Media List.....	18
TV APPS	
Media List	
Recording & Playback.....	24
Recording	
Playback	
Search.....	29
Search	

Settings	30
Parental Control	
Preferences	
Channels	
Update	
System	
Appendix.....	36
Trouble Shooting	
HUMAX Customer Support	
Error Messages	
Using the Universal Remote Control	

Accessories

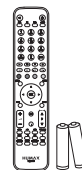

Remote Control
/ Batteries

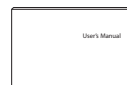

User's Manual



Screws

Note: This accessories may vary according to area.

Front & Rear

Note: The image may differ from the actual product.

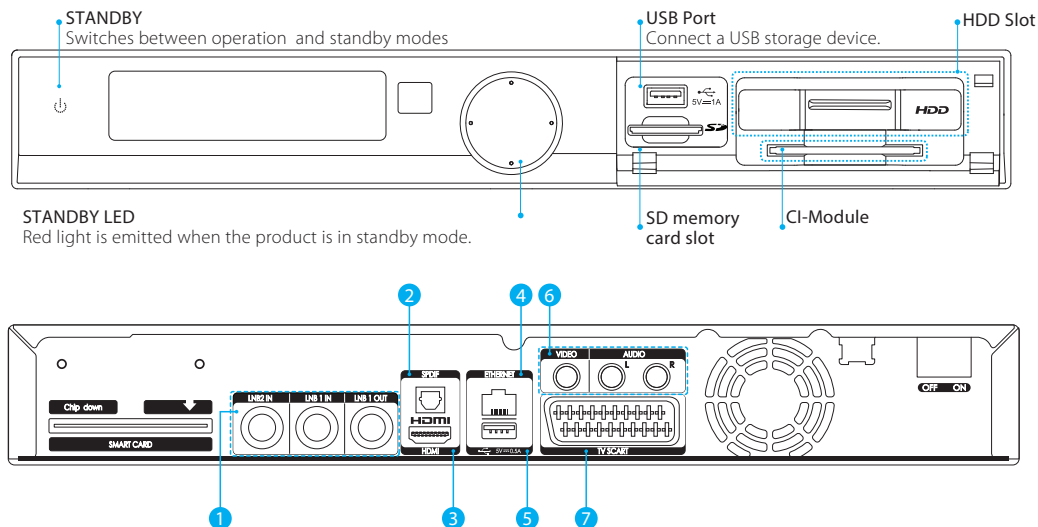

- 1 **LNB 1 IN, LNB 2 IN:** Connect a satellite antenna cable. You can connect up to two cables.
LNB 1 OUT: Connect another digital satellite receiver.
- 2 **SPDIF:** Use an S/PDIF cable to connect to the audio system for digital audio.
- 3 **HDMI:** Use an HDMI cable to connect to the TV.
- 4 **ETHERNET:** Service port / Connect a LAN cable.
- 5 **USB Port:** Connect a USB storage device.
- 6 **VIDEO/AUDIO:** Use an RCA cable to connect to the TV or VCR.
- 7 **TV SCART:** Use a TV SCART cable to connect to the TV.

Inserting the CI-Module

1. Keep the CI-Module horizontal.
2. Insert the CI-Module into the slot.

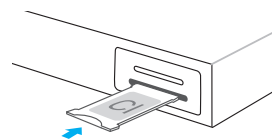

Inserting the Smartcard

1. Hold the Smartcard horizontally with the electronic chip facing downwards.
2. Insert the Smartcard into the slot on the rear panel.

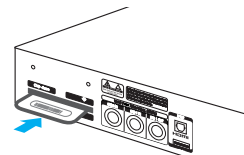

Assembling the HDD

1. Mount the HDD into the HDD cartridge.
2. Assemble the HDD with four screws on the bottom of the cartridge.

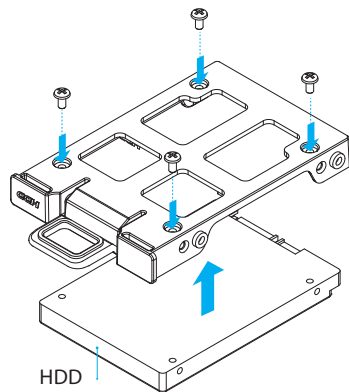

Detaching the HDD Cartridge

1. Turn off the power.
2. Press down the HDD cartridge gently until you hear a clicking sound.
3. Keep pressing down and pull out the HDD cartridge.

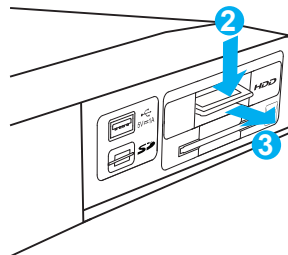

Attaching the HDD Cartridge

1. Turn off the power.
2. Push in the HDD cartridge until you hear a clicking sound.

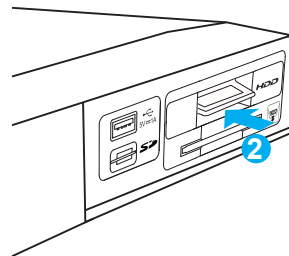

Note: We recommend to use HUMAX HDD. In case you use another HDD, please check the maximum operating temperature of the HDD is 70°C.

Remote Control

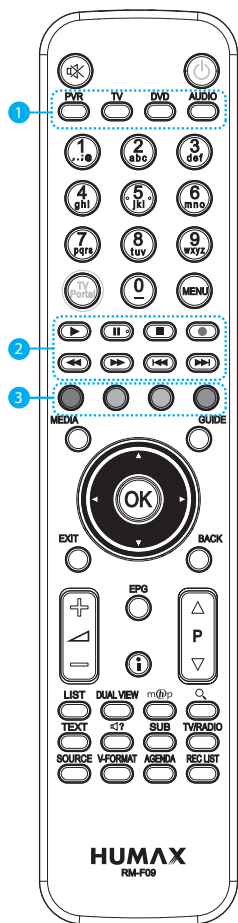

	MUTE	Mutes audio
	STANDBY	Switches between operation and standby modes
1	MODE	Changes the remote control mode
	NUMERIC	(0-9)
	TV Portal	Enters HUMAX TV Portal
	MENU	Displays the main menu
2	Playback Control Buttons	► Play, II Pause, ■ Stop, ● Record, ◀◀ Rewind, ►► Fast Forward, ◀◀ Previous, ►► Next
3	COLOUR Buttons	For interactive applications
	MEDIA	Displays the media list
	GUIDE	Displays Now & Next guide
	ARROW Buttons	Moves the cursor up, down, left or right
	OK	Selects a menu or confirms
	EXIT	Exits all On-Screen Display (OSD) screens
	BACK	Returns to the previous channel or the previous screen
	▲ +/-	Changes the audio volume
	P ▲/▼	Changes the channel
	EPG	Displays Tivu guide
	I(Information)	Displays the channel and program information
	LIST	Displays the channel list
	DUAL VIEW	Displays two programs
	mhp	Displays MHP application information
	Search	Searches programs
	TEXT	Enters the digital text service
	AUDIO	Changes the audio language

	SUBTITLE	Changes the subtitle language
	TV/RADIO	Switches between TV and radio modes
	SOURCE	Switches between the input sources from SCART
	V-FORMAT	Sets the resolution of screen
	AGENDA	Displays the scheduled programs
	REC LIST	Displays the scheduled recordings

Quick Start Guide

Inserting Batteries

Insert the batteries matching the plus(+) and minus(-) at each end.

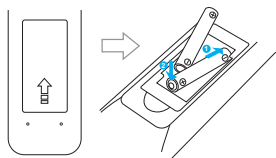

Customer Information

Concerning the "Application of the Directive 2008/103/CE regarding batteries, accumulators and the related waste disposal."

Your remote control needs 2 batteries AAA type, 1.5VDC. The batteries included don't contain mercury (Hg), cadmium (Cd) or lead (Pb).

Do not mix different types of batteries or new and old batteries.

Do not use rechargeable batteries. In order to avoid any risk of explosion, observe polarities indicated inside the battery compartment. Replace only with the type of batteries specified above. Do not throw them into fire, do not recharge them. If you are not using the remote control for a long period of time, remove the batteries. Please respect the environment and recycling regulations! Batteries must be collected separately from other refuse!

Connections

This section describes how to connect your product to match your particular devices and to gain optimum signal quality.

Warning: Connect all devices before you plug any power cords into the wall outlet. Always turn off the product, TV and other devices before you connect or disconnect any cables.

Note: If you encounter any problems setting up your product, please contact your local retailer or HUMAX Customer Service.

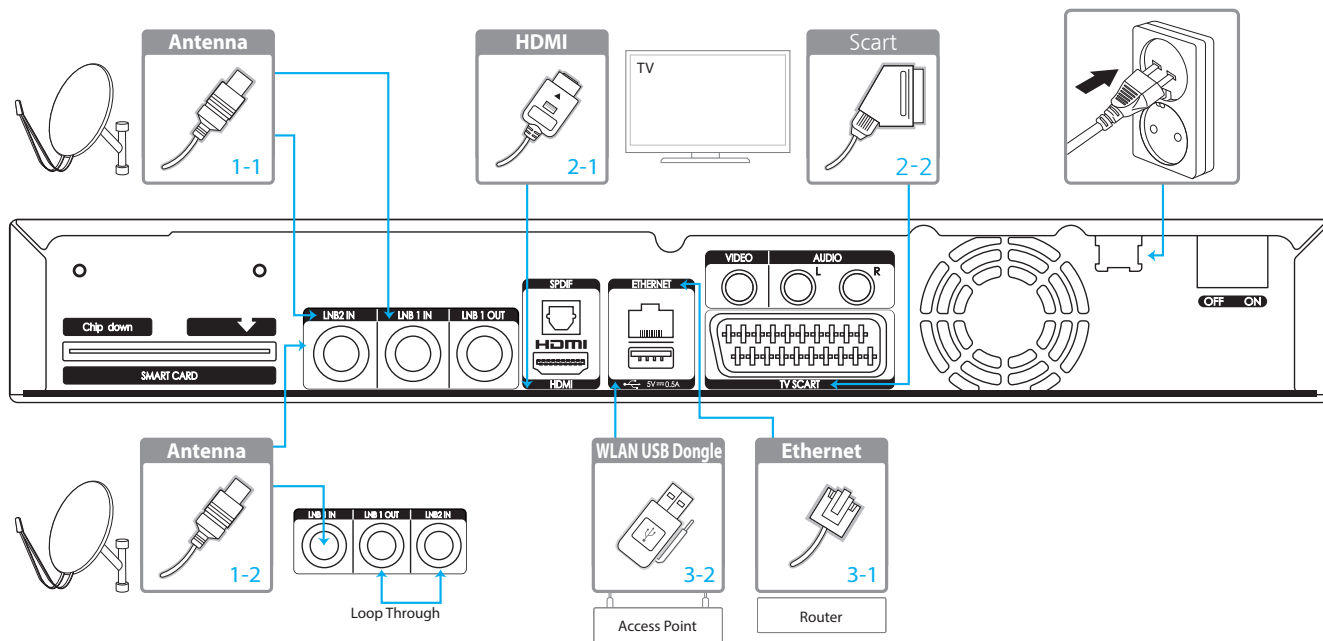

Connecting the Antenna

1-1 Connecting to Two Cables

Connect two satellite coaxial cables from the wall directly to the LNB 1 IN and LNB 2 IN connectors.

Note: This connection will allow you to watch another channel while recording a channel or record programmes from two different channels at the same time.

1-2 Connecting to One Cable (loop-through)

1. Connect a satellite coaxial cable from the wall to LNB 1 IN connector.
2. Use a Loop-through cable to connect the LNB1 OUT and LNB2 IN.

Note:

- When you use this connection, the specified functions for 2 tuners will not be available.
- When you use a Motorised System or SCD Antenna (also known as Unicable), connect the satellite coaxial cable only to LNB 1 IN connector.

Connecting the TV

2-1 Using an HDMI cable

For the best picture quality, use an HDMI cable to connect to the TV.

2-2 Using a SCART cable

For good picture quality, use a SCART cable to connect to the TV.

Note:

- Use an S/PDIF cable to connect to the audio system for digital audio.
- Programs restricted by Digital Rights Management (DRM) may not be viewed via the HDMI cable. You cannot use an HDMI cable for programs that use DRM. For programs that use DRM, use a SCART or composite cable.

Connecting the Network

3-1 Connecting to the LAN

1. Use the Ethernet cable to connect the product and the LAN router.
2. Set the options for the LAN. (Refer to **System>Network Setting** for details.)

3-2 Connecting to the Wi-Fi

1. Plug the wireless USB dongle into the USB port. (Separate purchase required)
2. Set the options for the Wi-Fi. (Refer to **System>Network Setting** for details.)

Note:

- We recommend the network connection over a direct LAN.
- Make sure that the distance between the Wi-Fi access point and the product is not too far away. This may lower the quality of service.

Powering On

1. Connect the power cord of the product to a wall outlet.
2. Make sure that the **ON/OFF** switch at the rear of the product is switched to **ON**.
3. Power on by pressing the **STANDBY** button on the remote control or the **STANDBY** button at the front panel.

Wizard

The installation wizard operates automatically when you power on the product for the first time or do factory default in menu.

Note: If you exit the installation wizard without fully completing the channel searching procedure, you may not have all of the channels available. In this case, go to **MENU > SETTINGS > CHANNELS > SEARCH CHANNELS** and search for more channels.

1. Language

Select your language.

2. PIN code

Enter a PIN code.

3. Video

Set the video output to your TV.

4. Antenna

Set the antenna type and satellite options.

Refer to **Settings > Channels > Setting Antenna** for more details.

5. Channel



Set the search options and then search channels.

Save the found channels when the search is complete.



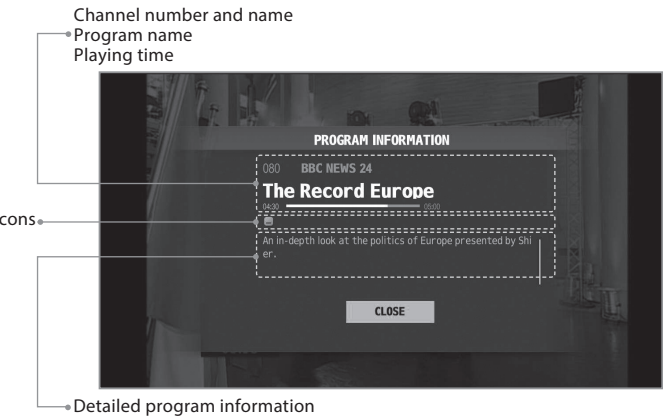







Program Information

The program information is displayed when you press the **i** button. Press the **i** button again to close the popup window.

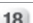
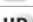

	Program information Press the i button to display program information.
	Detailed program information Press the ▲/▼ button to scroll up or down in detailed program information.

Icons



	Locked Program
	Scrambled Program (CAS icons)
	Teletext
	Recording
	Unrecordable program
	Scheduled recording
	Scheduled watching
	Parental level (minimum age for viewing)
	HD program
	Subtitle
	Multiaudio
	Dolby Digital audio
	Dolby Digital Plus audio

Channel List

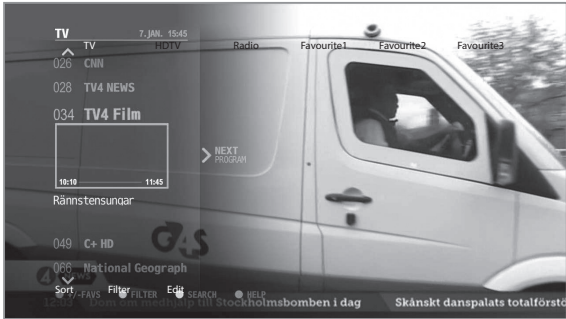
Press the **LIST** button to access the channel list.









Changing Channels

	<p>Changing Channels</p> <p>Press the ▲/▼ button to select a channel in the channel list. Select a channel and press the OK button. The channel displays.</p>
	<p>Listing Future Programs</p> <p>Press the ► button to list future programs. Select a future program and press the OK button. You can set a reminder on the program.</p>

Note: Press the **EXIT** button to exit. Press the **BACK** button to return to the previous screen.

Editing Channels in Channel List

	<p>Adding Favorite Channels</p> <p>Select the channel to add using the ▲/▼ button and then press the RED button. Select a favorite group.</p> <p>Removing Favorite Channels</p> <p>Select the channel to remove using the ▲/▼ button and then press the RED button. Select a favorite group.</p>
	<p>Filtering Channels</p> <p>Press the GREEN button to filter the channels according to the channel type. (All, Favs., Provider)</p>
	<p>Searching Programs</p> <p>Press the YELLOW button to search programs. Press the OK button to enter a keyword.</p>
	<p>Viewing Information & Help</p> <p>Press the BLUE button to view more information when you manage channels.</p>
	<p>Press the i button to view the detailed program information.</p>
	<p>Setting Reminder</p> <p>Press the OK button on the future program to set a reminder.</p>
	<p>Setting Recording Reservation</p> <p>Press the REC button on the future program to set a recording reservation.</p>

Note: To edit multiple channels, go to **MENU > SETTINGS > CHANNELS**.

Editing Tivùsat Channels

 **MENU** > SETTINGS > CHANNELS > EDIT TIVUSAT CHANNELS

1. Select a channel and then press the **OK** button.
A popup window displays.
2. Enter a new channel number and then press the **OK** button.
3. Press the **OK** button again. Virtual keyboard displays.
4. Enter a new channel name.
5. Select **Done** to complete the channel information change.

Editing Channel Information

 **MENU** > SETTINGS > CHANNELS > EDIT CHANNEL INFO

1. Select a channel and then press the **OK** button.
A popup window displays.
2. Enter a new channel number and then press the **OK** button.
3. Press the **OK** button again. Virtual keyboard displays.
4. Enter a new channel name.
5. Select **Done** to complete the channel information change.

Note: If you edit a channel number or name, all recording reservations and reminders are deleted.

Deleting Channel

 **MENU** > SETTINGS > CHANNELS > DELETE CHANNEL

1. Select a channel in the left column and then press the **OK** button.
The deleted channels are listed in the right column.
2. Press the ◀/▶ button to move between the left and right columns.
3. Press the **YELLOW** button to save the changes.

Editing Favorites

 **MENU** > SETTINGS > CHANNELS > EDIT FAVORITES

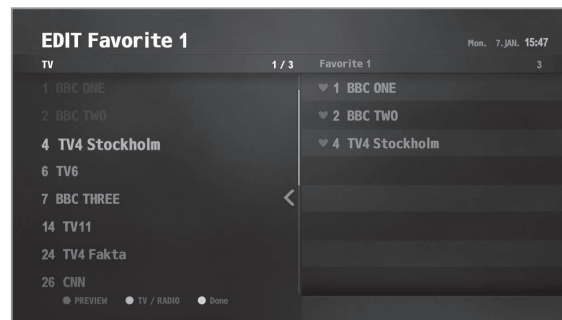

Adding Favorite Channels

1. Select a favorite group to edit.
2. Select a channel in the left column and then press the **OK** button.
The channel is added to the favorite list.

Removing Favorite Channels

1. Select a favorite group to edit.
2. Select a channel in the right column and then press the **OK** button.
The channel is removed from the favorite list.

Changing order

1. Select a favorite group to edit.
2. Select a channel in the right column and press the **GREEN** button.
3. Press the ▲/▼ button and then press the **OK** button to complete the order change.

Renaming Favorites



1. Select a favorite group to edit.
2. Press the **RED** button. The virtual keyboard displays.
3. Enter a new name.
4. Select **Done** in the virtual key board to save the new name.

Dual Watching

You can watch two channels at the same time.

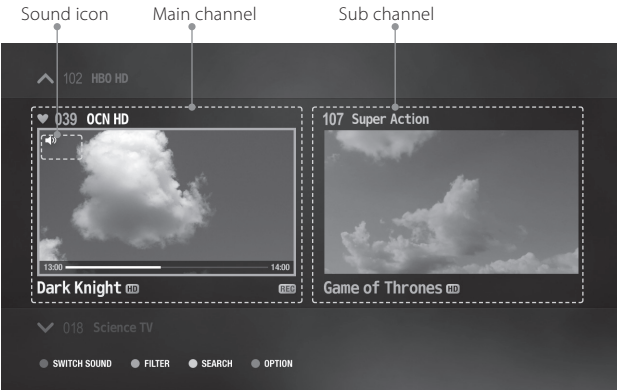
- Press the **DUAL VIEW** button.



	<p>Switching Sound</p> <p>Press the RED button to switch sound between two channels.</p>
	<p>Press the OK button on the channel having sound, the channel will be tuned in full screen.</p> <p>Press the OK button on the channel without sound, the channel will have sound.</p>
	<p>Enter a channel number to directly tune to the channel.</p>

Note: You cannot enter dual view mode while recording a program.
Some features are not supported while in dual watching mode.

Live TV

1. Press the **MENU** button.
2. Select **LIVE TV** and press the **OK** button.

Note: Select **RECENT** to view the list of recently watched programs.

Now & Next



-  **MENU** > **LIVE TV** > **NOW & NEXT**
 You can view the current and future programs.
 Select a next program and press the **▶** button to list future programs.



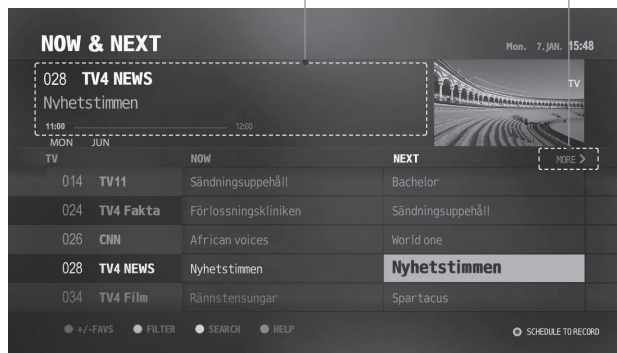



Information of the selected program

Channel number and name, Program name, Playing time Future program list



Note:

-  : Scheduled recording
-  : Scheduled watching
- Refer to **Managing Channels > Channel List** for more details about the color buttons.

	Setting Reminders Select a future program and press the OK button. You can set up to 20 reminders.
	Recording Program Select a current program and press the REC button. You can record two programs at the same time.
	Setting Recording Reservations Select a future program and press the REC button. You can set up to 20 recording reservations.
	Press the i button to view the detailed program information.
	Press the ◀/▶ button to move to the previous/next day while the future program list is displayed.
	Press the BACK button to close a popup window and return to the previous screen.

Channel Guide

 **MENU** > LIVE TV > CHANNEL GUIDE

Information of the selected program

Program name, Playing time and icons, Simple information Current date & time



Watching Programs

1. Select a current program and then press the **OK** button. The program displays in the preview.
2. Press the **OK** button again to watch the program.

Note:

- Enter a channel number to directly focus on the channel.
- To find a channel faster, long press the **▲/▼** button.
- To move to another day faster, long press the **◀/▶** button.

Setting Favorite Channels

1. Select the channel to add or remove from the favorite group and then press the **RED** button.
2. Select the favorite group to add or remove and then press the **OK** button.
3. Press the **BACK** button to close the popup window.

Filtering Channels

1. Press the **GREEN** button and select a group. The channels belonging to the group are listed.
2. Press the **BACK** button to close the popup window.

Scheduling Reminders and Recordings

1. Select a future program and press the **OK** button to set a reminder. Select a future program and press the **REC** button to set a recording reservation.
2. Press the **OK** or **REC** button again to cancel the reservation.

Viewing Scheduled Program List

 **MENU** > LIVE TV > SCHEDULED PROGRAMS

Select a program and press the **OK** button. Popup window displays. You can change the scheduled program to the recording reservation. Also, you can view the detailed program information.

TV APPS



TV APPS is the new name of HUMAX TV Portal which provides catch-up TV services and various web applications.

Note: Make sure to connect the network before using this service.

Read and agree to the privacy policy to use certain applications.

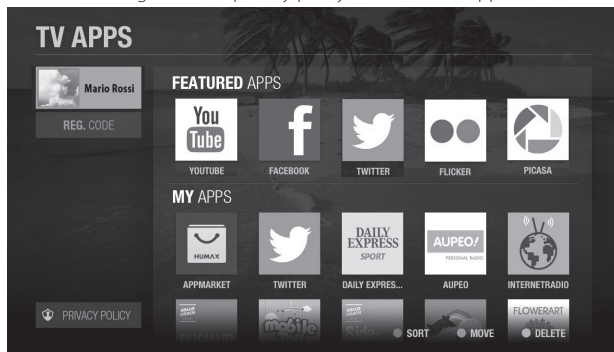

Creating Account

1. Go to <http://www.myhumax.net>.
2. Click **New account** and follow the instruction to create your personal account.

Note:

- You need to enter the registration code to register your receiver to HUMAX server.
Go to **MENU > MEDIA & APPS > TV APPS** and select **REG. CODE**.
The registration code is valid for 3 hours.
- You can create up to 4 personal accounts.

Featured Apps

You can access various applications which are listed for promotion. Try that!

MY Apps

Frequently used applications are listed depending on a personal account. You have to create your personal account at the website www.myhumax.net.

Social Networks

You can use social networks such as Facebook and Tweeter on your TV. Access myhumax.net and go to **Mypage**. You can connect your personal account to your social networks.

HUMAX Appmarket

You can download additional applications from HUMAX App market.

Note: HUMAX TV Portal is powered by independent service providers and the services are subject to change without notice. The services may be discontinued temporarily or permanently without further notice. HUMAX is not responsible for the content or the discontinuity of the services. Available services may vary depending on countries.

Media List

1. Press the **MENU** button.
2. Select **MEDIA & APPS** and press the **OK** button.

Note: Select **RECENT** to view the recently used media files.

You can play video, music or photo files stored in the hard disk drive, the USB storage devices or the home network devices.
Select the media type and press the **OK** button. You can view the media file list.

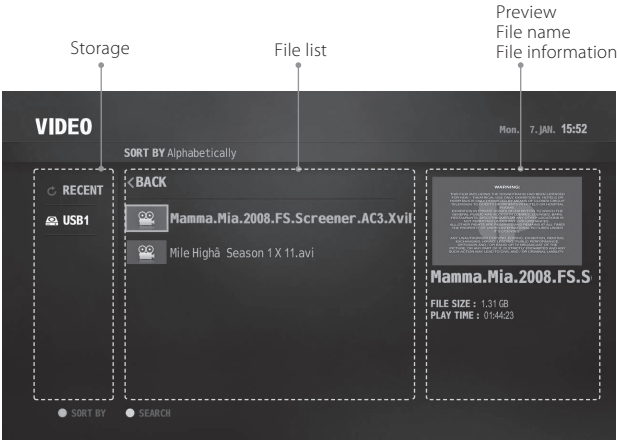

RED 	Deleting history Delete the files from the recent list.
GREEN 	Sorting files Sort files in alphabetical or time order.
YELLOW 	Searching files Search files in the storage by keywords.

Note:

- Make sure to connect the power if you use the USB storage device which requires an external power supply.
- If the USB storage device is connected in standby mode, it will automatically be recognised when the product is turned on.
- Do not disconnect the USB storage device during playback, the stored files or the USB storage device may be damaged.
- USB storage devices below USB 2.0 are supported, but they may not work properly.
- The network icon is displayed only when the network is connected.
- HUMAX cannot guarantee compatibility with all USB storage devices and assumes no responsibility for any loss of data.
- It is recommended to use the compatible SD memory card. The model names are listed on page 37.

	Selecting files Select a file. The file information displays in the preview.
	Playing files Playback starts from the beginning of the file.
	Switching storage Press the ◀ button to change the storage.

Using the Home Network Media Server

Your receiver is a home network compliant device capable of sharing media files with other home network compliant devices such as the PC, NAS or another HUMAX PVR when they are connected to the same home network. You can play the video, music or photo files that are stored in your PC on your receiver when the PC is connected to the same home network. You can also play the media files stored in your receiver on your PC.

Connecting to Home Network

1. Connect the receiver to your home network by connecting the router or the Wi-Fi access point.
2. Press the **MENU** button and go to **SETTINGS > SYSTEM > NETWORK SETTING**.
3. Set the options for the LAN or Wi-Fi. (Refer to **System > Network Setting** for details.)

Playing Files on Your Receiver

: Files stored in the PC, NAS or another HUMAX PVR

1. Press the **MEDIA** button.
2. Select the contents type.
3. Select a server from the storage list.
4. Select the files you want to play.

Note:

- Home network media server software such as Window Media Player 12 must be installed and executed on the PC to share media files stored in the PC. The media files must be stored in the library folder of the PC.

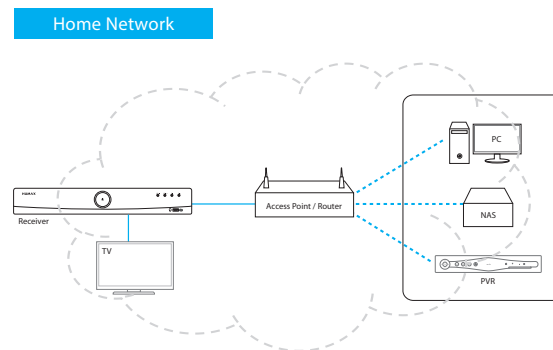

Video Player

You can play TV/radio recordings or video files stored in the hard disk drive, the USB storage device or the home network compliant devices.



- 1. Press the **MEDIA** button and select **Video**.
- 2. Select a storage and a folder.
- 3. Select a file and press the **OK** button. Playback starts.

You can perform rewind, fast forward, slow motion and pause while playing back a video file. Refer to **Recording & Playback > Playback** for details on playback control and playbar.

Note:

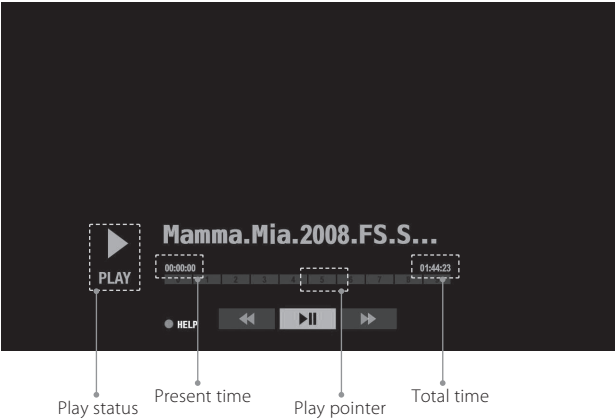
- You will be prompted to enter the password when you play the locked files.
- Files with DRM (Digital Rights Management) expiration dates may expire if you do not watch it before the written date.
- Some playback control buttons may not function depending on the contents.



	<p><i>Playing files</i></p> <p>Jump to the corresponding scene.</p>
	<p><i>Jumping scenes</i></p> <p>Go back or forward by 30 seconds.</p>

Music Player

You can play music files stored in the hard disk drive, the USB storage devices or the home network compliant devices.
Press the **MEDIA** button and select **MUSIC**.

Editing Playlist

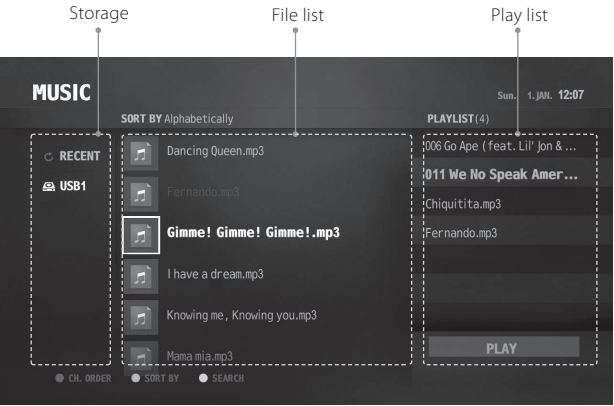

	Move the cursor between the file list and the play list.
	Select a file and press the OK button. The file is added or removed from the play list.
	Select a file in the play list and press the RED button. You can move the file using the ▲/▼ button. Press the OK button to complete the order change.

Playing Music

Select a file and press the **OK** or **PLAY** button. All files in the folder will play successively.
To play the selected files only, select the files using the **RED** button and press the **OK** or **PLAY** button.

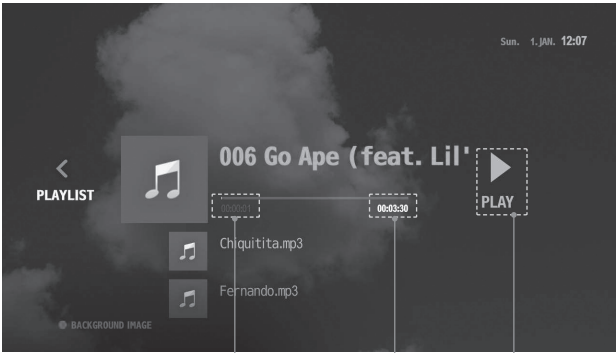

	Selects the previous or next file
	Plays or pauses
	Displays background
	Goes to play list

Photo Viewer

You can play photo files stored in the hard disk drive, the USB storage devices or the home network compliant devices.

- 1. Press the **MEDIA** button and select **PHOTO**.
- 2. Select a storage and a folder.
- 3. Press the **OK** button. You can view all files in the folder.



Function buttons





	Move the cursor to select a photo.
	Display the selected photo in a full screen.
	Zoom in or out of the photo.
	Play or pause slideshow.
	Rotate the photo clockwise or counterclockwise.

Photo Slideshow

You can set the slideshow time and play music during slideshow.

- 1. Press the **BLUE** button.
- 2. Select **SLIDESHOW TIME** or **MUSIC SET**
 - **SLIDESHOW TIME** : The duration a photo is displayed
 - **MUSIC SET** : Music files during slideshowSelect a music file from the recent list.
- 3. Press the **OK** button to save and exit.

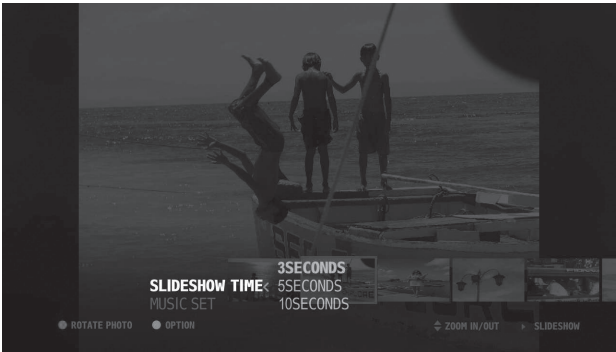

Recording

You can record a program while you are watching another program or record two other programs at the same time.

Connecting a Detachable Hard Disk Drive

When you connect a detachable hard disk drive for the first time, you will be prompted to format the hard disk drive. All data will be removed after formatting.

1. Connect the detachable hard disk drive to the HDD slot at the front panel.
2. A message will appear. Select **YES** and press the **OK** button.
3. To format the storage manually, go to **MENU > SETTINGS > SYSTEM > HDD FORMAT**.

Formatting may take several minutes depending on the size of the hard disk drive.

Note:

- You can purchase the detachable HDD as a separate accessory.
- It is recommended to use the detachable hard disk drives that are supplied by HUMAX. We guarantee the detachable hard disk drives from HUMAX only.
- Please do not disconnect the HDD while recording or playing back. When the HDD is suddenly detached, the stored files or the HDD may be damaged.

Instant Recording

You can record the current program and set the recording duration.

1. Press the **RECORD** button. The popup window displays.
2. Enter the recording duration.
If you do not input recording duration within 5 minutes, the recording will continue for two hours.
3. Press the **STOP** button to stop recording.

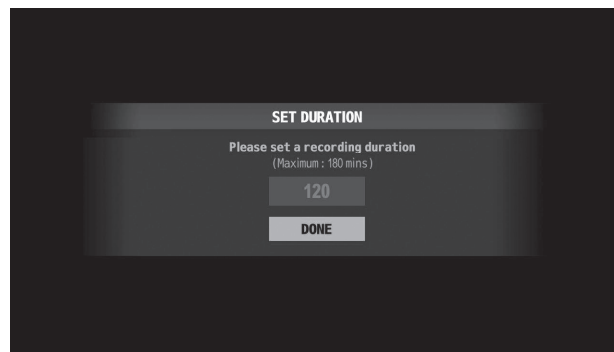

Manual Recording

You can set recording reservations for a single episode or multiple episodes.
Go to **MENU > RECORDING > MANUAL RECORD** to set a recording reservation.

MANUAL RECORDING Sun. 1. JAN. 12:13

CHANNEL	REPEAT	DATE	TIME
070 CBBC Channel	YES	TUE.WED	08:00-09:00

Channel Selection:

- ☒ YES
- ☐ NO
- CBBC Channel**
- CH LIST**

Repeat Options:

- ☐ EVERYDAY
- ☐ EVERY SUN
- ☐ EVERY MON
- ☒ EVERY TUE
- ☒ EVERY WED
- ☐ EVERY THU
- ☐ EVERY FRI
- ☐ EVERY SAT

Time Selection:

START TIME: 08:00

END TIME: 09:00

Buttons: DONE, CANCEL

1. **Searching channels**

Press the **OK** button to enter a channel name directly.
Select the **Ch.List** to search a channel. A popup window displays.

2. **Setting repeat option**

Select **Yes** or **No** to record the channel repeatedly or not. You can choose a day or a date on the next field.

3. **Setting day or date**

Select a day or date.

4. **Setting time**

Enter the start time and end time (00:00 ~ 24:00).

5. **Completing reservation**

Select **DONE** to complete the recording reservation.

Recording Conflict

If you try to record more than two programs at the same time, tuner conflict occurs. You can resolve the tuner conflict as follows:

When you try to record a program while recording two other programs, you can either

- stop one of the recordings or
- cancel the new recording.



When a scheduled recording is about to start while recording two programs, you can either

- stop one of the current recordings or
- cancel the scheduled recording.

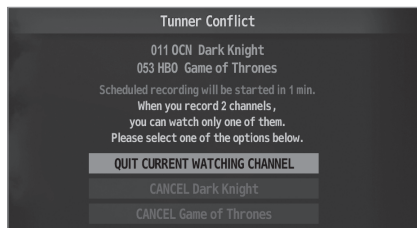

When a scheduled recording is about to start while you are watching two programs in dual view mode, you can either

- exit the dual view mode or
- cancel the scheduled recording

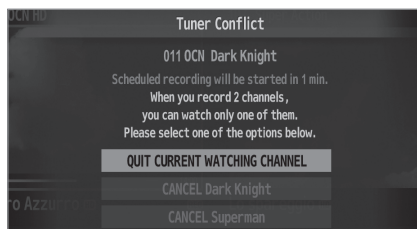

You can view the list of scheduled recordings in time order. Go to **RECORDING > UPCOMING RECORDING** to edit the scheduled recordings.

UPCOMING RECORDING				Mon. 31.OCT. 04:51
TODAY	05:00-06:30	BBC THREE	This Is BBC THREE	
	07:00-10:15	BBC ONE	Breakfast	
	07:00-13:00	BBCi	BBCi	
	15:00-15:30	TV6	Simpsons	
	15:30-17:25	TV4 Stockholm	Holy man	
TOMORROW	19:00-20:00	BBC ONE	BBC ONE - Jan.01 19:00	
	08:00-09:00	CBBC Channel	CBBC Channel - Jan.03 08:00	
	11:00-12:00	TV4 NEWS	Nyhetstimmen	

- Select a scheduled recording and press the **OK** button. Program information displays on a popup window. You can cancel or edit a recording reservation on the popup window.
- Press the **BACK** button to return to the previous screen.

Setting Recording Options

 **MENU** > RECORDING > PREFERENCES

- **Auto Delete for single recording** : Period of saving the recording
- **Auto Delete for repeated recording** : Number of saving the repeated recordings

Note:

- If a scheduled recording is about to start while you are recording one program, the record banner will display for a few seconds to remind you. If you are not watching the channel being recorded, a record notice will pop up 30 seconds before the scheduled recording starts, and the channel will switch to the scheduled program automatically at the start time.
- The recording will not stop even if you press the **STANDBY** button. New recordings will start even in standby mode.
- While watching a recording program, you can trick-play using the playback control buttons such as pause, fast rewind, instant replay, slow, etc.
- You can record the digital TV programs only. You cannot record the audio and video input from the external device.
- Make sure that there is enough free space before recording. If there is no sufficient space on the hard disk drive, the recording will stop. The space for recording a 1 hour program may differ depending on the program.





Playback

You can play back the recorded programs that are stored in the hard disk drive.

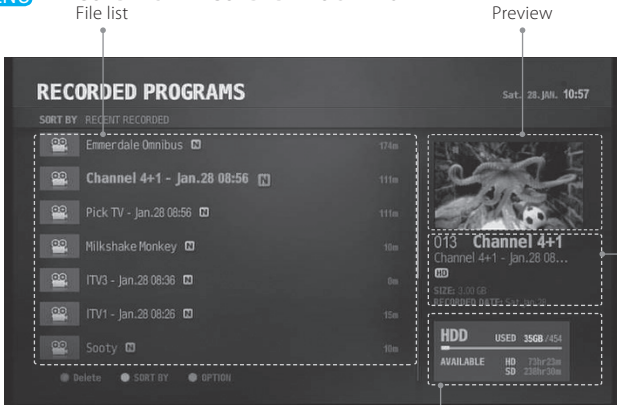
Recorded Programs

 **MENU** > RECORDING > RECORDED PROGRAMS



	You can select a recorded program.
	Deleting Files Delete the file you select.
	Sorting Files Sort the recorded programs in alphabetical or time order.
	Renaming Files Enter the name of the file in the keyboard. Saving Files The file is not deleted automatically until you delete file.

Playback Controls

Select a file and press the **OK** button. Playback will start.



	Play
	Pause the scene.
	Stop playback and go to live TV.
	Rewind
	Fast Forward
	Replay scene.
	Skip scene.

Note: Press the numeric button to jump to the corresponding scene.

Pausing and Rewinding Live TV (TSR)

Time Shifted Recording (TSR) allows you to pause a live broadcast and return later where you left off. The TSR function temporarily saves the program you watch to the hard disk drive automatically. TSR lasts for 90 minutes.

To pause the program you are watching

Press the **II** button. Press the **►** button to return. Pause makes a time gap between the live broadcasting point and watching point. The time gap is equivalent to the period the program has been paused. Press the **■** button to close the time gap and go to live program.

To rewind and watch missed scenes

Press the **◀◀** button. Press the **►** button at the point where you want to start watching. You can pause, rewind or fast forward within the program. You can fast rewind back to the start point. If you reach the start point while rewinding, the program automatically plays at normal speed.

To fast forward and skip scenes

Press the **▶▶** button. You can fast forward only when there is a time gap between the current watching point and the live broadcasting point caused by pause, slow motion or rewind. You can fast forward up to the current broadcasting point. If you reach the live broadcasting point while fast forwarding, the program automatically plays at normal speed.

Search



If you cannot remember a program title, or are not sure how to find it again, press the **SEARCH** button. You can search TV programs or media files by key words.

Searching files

1. Press the **SEARCH** button.
2. Press the **OK** button to display a virtual keyboard.
3. Enter a keyword on the virtual keyboard.
You have to enter at least two letters.
4. Select **Done** to complete.
All searched files are listed in alphabetical order.

Note: You cannot search media files stored in the Home network compliant devices.

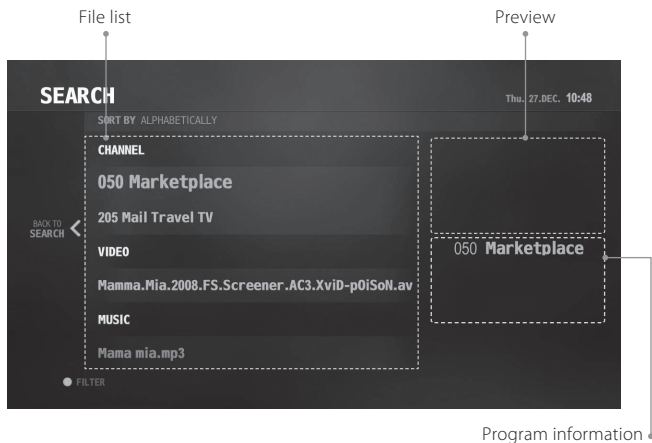

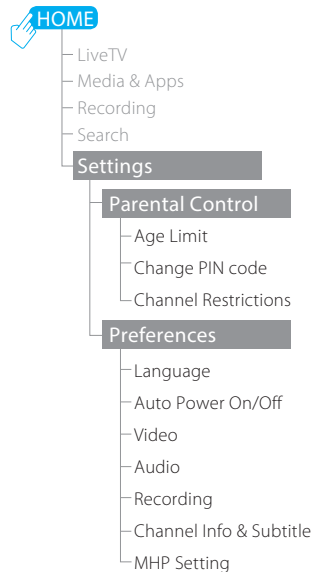

Parental Control

Age Limit

You can block the program if the program is above the age limit. (**View All, 7, 12, 15, 18, Lock All**)

Change PIN code

Enter a new PIN code.

Channel Restrictions

You can set channels lock to restrict viewing of some channels.

Note: Enter the password to view the blocked programs.

Preferences

Language

You can set the system language, audio language and subtitle language.

Auto Power On/Off

You can set the time the receiver powers on or powers off.

Note: Make sure the power on timer and power off timer are set differently from each other.

Video

- **Screen format :** You can select the screen ratio and

display format of your TV. (**16:9 Auto – 16:9 Pillarbox – 16:9 Zoom – 4:3 Auto - 4:3 Latterbox - 4:3 Centre**)

- **Resolution :** You can select the resolution of your TV (**576i – 576p – 720p – 1080i -1080p**)
- **TV SCART Output :** You can select the video signal output option. (**CVBS - RGB**)

Audio

- **Digital Audio Output :** You can select the digital audio signal output. (**Multi-Channel - Stereo**)
- **Lip-Sync :** You can adjust the sound difference between audio and video.
- **Downmix Mode:** You can adjust the multiple audio channels. (**Surround - Stereo**)

Channel Info & Subtitle

You can set the duration the channel information is displayed and the subtitle font.

MHP Setting

You can set the MHP setting options.

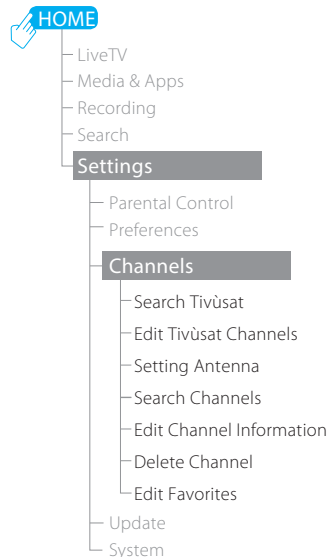

Channels

Search Tivùsat

1. Select **Search Tivùsat** and press the **OK** button to search for tivùsat channels.
2. When the search is complete, select **Save** and press the **OK** button to save the found channels.

Note: **Search Tivùsat** is activated only when the satellite is set to **HOT BIRD**.

Setting Antenna

Set your antenna type before you search channels.

Fixed-LNB only

When you use the fixed antenna and LNB switch only,

1. Select **FIXED-LNB Only**.
2. Set the satellite options.
 - **Satellite:** Select the satellite.
 - **LNB Frequency:** Select the LNB frequency.
 - **Test Transponder:** Check the signal status of each transponder and select the one with the best quality.
3. Select **OK** to complete.

Fixed-DiSEqC

When you use the fixed antenna and DiSEqC switch,

1. Select **FIXED-DISEQC**.
2. Set the satellite options.
 - **Satellite:** Select the satellite.
 - **LNB Frequency:** Select the LNB frequency.
 - **22kHz Tone:** Select **On** when using a 22kHz tone switch box.
 - **DiSEqC:** Select the DiSEqC switch.
 - **Test Transponder:** Check the signal status of each transponder and select the one with the best quality.
3. Select **OK** to complete.

SCD

Single Cable Distribution enables the delivery of broadcast programming over a single cable to multiple users eliminating the numerous cables required to support other electronics devices.

If you are using more than one satellite receiver, set one receiver at a time and turn off the others while setting.

1. Select **SCD**.
2. Set the satellite options.
 - **Satellite:** Select the satellite.
 - **LNB Frequency:** Select the LNB frequency.
 - **Tuner 1:**
 - Select the user band from 1 to 8.
 - Select the user frequency based on the user band of tuner 1.
 - Check the signal status of each transponder and select the one with the best quality.
 - **Tuner 2:** Set the user band, the user frequency and the test transponder in the same way as in Tuner 1.
3. Select **OK** to complete.

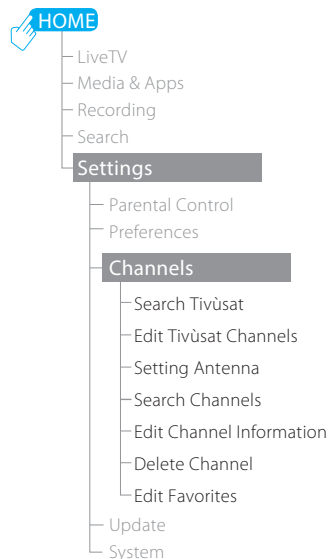

DiSEqC 1.2

DiSEqC 1.2 allows switching between up to 16 sources, and controlling a single axis satellite motor.

1. Select **DiSEqC 1.2**.
2. Set the satellite options.
 - **Satellite:** Select the satellite.
 - **LNB Frequency:** Select the LNB frequency.
 - **Position Setting:**
 - Select the motor driving, and set the driving size from 1 to 127.
 - Fine-tune the position using the ◀/▶ button until the signal strength and quality reach the maximum level.
 - Save the adjusted position.
 - Check the signal status of each transponder and select the one with the best quality.
3. Select **OK** to complete.

USALS

Universal Satellites Automatic Location System is a satellite dish motor protocol that automatically creates a list of available satellite positions in a motorized satellite dish setup.

You can set the position of the satellites when you use a motor antenna for efficient channel search.

1. Select **USALS**.
2. Set the satellite options.
 - **Satellite:** Select the satellite.
 - **LNB Frequency:** Select the LNB frequency.
 - **Longitude:** Enter the longitude and direction.
 - **Latitude:** Enter the latitude and direction.
 - **Test Transponder:** Check the signal status of each transponder and select the one with the best quality.
3. Select **OK** to complete.

Search Channels

You can check the satellite information and edit the satellite options.

1. Select a satellite and press the **OK** button to edit.
2. Set the satellite options.
 - **Transponder:** Check the signal status of each transponder and select the one with the best quality.
 - **Search Type:** Select the type of channels you want to search.

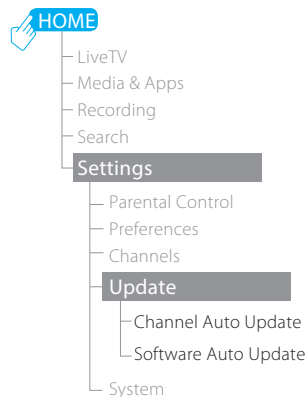

Update

Channel Auto Update

You can set the automatic channel search to be activated in standby or operation mode.

Software Auto Update (OTA)

To maintain proper performance, it is essential to have the latest software. We recommend that you set the software to be updated automatically.

OTA, an abbreviation of Over-the-Air, means that the software can be downloaded through your aerial.

The manufacturer reserves the right to decide when and where to release software by this process.

Note:

- It may take 5~10 minutes to update the software.
- Other functions such as scheduling programs will not activate during software update.
- Make sure to update software when the signal strength and quality are high. If the weather is not favorable and the signal strength and quality are not recommendable, perform the software update later.
- The product will search new software automatically during standby. If new software is detected, you can choose to download immediately when you switch into operation mode.
- You can also update the software by connecting a USB device which has the new software file. You can download new software from the HUMAX website.

Caution:

- Be careful to keep the power on and the power cord plugged in during software update. If the power is off during software update, fatal damage may occur to the product.
- Be careful not to pull out the signal line (RF cable) during software update. Update may be interrupted and the product may not operate.

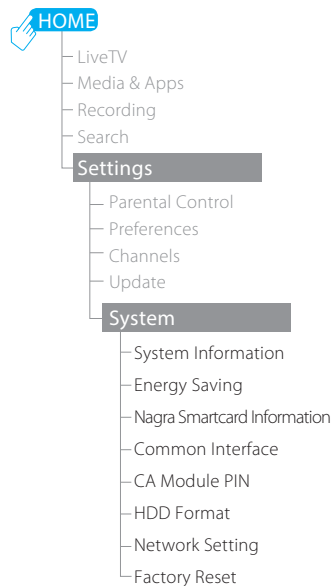

System

System Information

You can view the system information.

Energy Saving

- **Power Saving in Standby:** Set the timer to reduce the power consumption in standby to below 0.5W. This is to comply with the rules of energy using products (EuP).
- **Automatic Power Down:** Set the timer to enter standby mode automatically if no user interaction occurs for hours (**Off, 2hr, 3hr, 4hr, 5hr**).

Note:

- A message will display 30 seconds before the product enters standby mode. If you ignore this message, the product enters standby mode automatically.
- If you connect two receivers using a loop-through cable, the loop-through function does not work when **Power Saving in Standby** is set to **On**. Even when **Power Saving in Standby** is set to **Off**, some channels may not be tuned. This is to enable software update whenever new software is available.

Nagra Smartcard Information

You can view the Nagra Smartcard information.

Common Interface

You can view the common interface information.

CA Module PIN

Enter a conditional access module PIN of your CI module to record digital broadcasts.

HDD Format

Format the detachable HDD.

Note: All files are deleted after format.

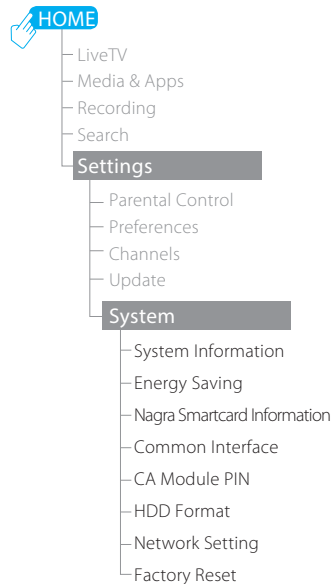

Network Setting

Note: This function is available only when the Ethernet cable has been connected to the receiver. Make sure that the Ethernet cable is connected correctly. Refer to **Connecting the Network** for details.

Configuring Wi-Fi (wireless)

1. Select **Wi-Fi Setting**.
2. Set the Wi-Fi to **ON**.
Available Wi-Fi networks are listed.
3. Select a Wi-Fi network from the Wi-Fi network list.

Note: If your Wi-Fi network is not listed, select **Add Wi-Fi Network** and enter your network name in the keyboard.

Configuring LAN

1. Select **LAN Setting**
2. Select your IP configuration type between **Automatic** and **Manual**.
 - **Automatic** : If you use a router or modem that has a DHCP (Dynamic Host Configuration Protocol) server function, select **Automatic**. The IP address will automatically be determined.
 - **Manual** : If there is no DHCP server on the network and you want to set the IP address manually, select **Manual**. Enter the values for IP address, subnet mask, gateway address and DNS address
3. Select **APPLY** to connect to the selected network and press the **OK** button.

Note : When entering the IP address manually, enter 4 digits in a row.

Factory Reset

1. Select **FACTORY RESET** and then **YES**.
2. You will be prompted to enter your PIN code. Enter the PIN code.

Note: To format the HDD, mark **Format HDD**.

Warning: Note that once you perform factory default, all user configured data will be reset. Shortly after you complete the factory default, the installation wizard will appear automatically.

Trouble Shooting

Before contacting the customer service centre, make sure to read the tips below carefully. If the problem persists after you complete the following procedure, please contact HUMAX customer service for further instructions.

1. **No message is displayed on the front display. (The product will not switch on.)**
 - Check the main power cable and make sure it is plugged into a suitable power outlet.
 - Check that the power supply is switched on.
 - Try connecting the power cable to a different power outlet.
 - If the product has a power switch on the rear, make sure it is switched on.
2. **No picture**
 - Press the **STANDBY** button and make sure that the product is powered on and is in operation mode.
 - Make sure that the audio/video cable is firmly connected to the TV.
 - Make sure that the antenna cable is properly connected to the product.
 - Be sure to activate channel search.
 - Check the brightness level of the TV.
 - Check if the channel is currently on air.
 - Make sure that STB or PVR is selected as input on the remote control.
 - Make sure that the antenna setting in the menu is correct. (satellite only)
3. **Poor picture/sound quality**
 - Make sure there is no mobile phone or microwave oven near the product.
 - Keep the power cable and the RF cable apart from each other.

Note: If the antenna is covered with snow or the RF is weakened by heavy rain, the condition of the sound and picture may temporarily be poor. However, poor sound and picture quality due to weather conditions cannot be accepted as a malfunction of product.

[Satellite]

- Check that your dish alignment is correct.
- Change the satellite dish for a larger one to increase the signal levels received.
- Replace the LNB with a lower noise factor in case the noise factor is too high.
- Replace the LNB with a new one in case it is damaged or out of order.

- Install the antenna in an obstacle-free place.
 - Check the signal levels and adjust your antenna if the level is too low. The signal level may be affected by weather conditions [Terrestrial]
 - Adjust the antenna direction to get a better picture.
 - If you are using an active antenna, turn the antenna power on in the menu to improve the reception.
4. **No or poor sound**
 - Check that your audio/video cable is connected correctly.
 - Check the volume levels of your TV and the product.
 - Check if either the TV or the product is on mute.
 - Check the audio type or soundtrack option if available.
 5. **Remote control does not operate.**
 - To control the product, point the top end of the remote control directly towards the remote sensor.
 - Remove and reinsert the batteries in the remote control or replace them with new ones.
 - If you are using a universal remote control, set the input of the remote control to STB or PVR mode.
 6. **Cannot make reservations.**
 - Check that no previous reservations are conflicting with the new reservation.
 7. **Channel search does not work.**
 - **[Satellite]** Make sure that the antenna setting in the menu is correct.
 - **[Cable]** Make sure that your cable is connected correctly.
 - **[Terrestrial]** Use the appropriate antenna capable of receiving VHF or UHF channels for your area.
 8. **Cannot update new software.**
 - If the product does not show a message requesting update, this means no software is available.
 9. **Cannot watch scrambled channels.**
 - Check that you have the appropriate Smartcard or CI-Module. Reinsert the Smartcard or CI-Module and make sure it initialises correctly.
 - Check in the menu that the product is detecting the Smartcard or CI-Module.
 - Check in the menu that you have a valid subscription to the channels you want to view.

Appendix

- Make sure that the Smartcard or CI-Module is not damaged.
- 10. Cannot watch pay channels.**
- Check in the menu that you have a valid subscription to the channels you want to view. Contact your network operator for more information.
- 11. The product makes a humming noise.**
- The noise is from the fan and this means the hard disk is operating normally. This kind of noise is inevitable but seldom noticeable.
- 12. Cannot record programmes. (PVR only)**
- The hard disk is full. Delete unnecessary programs and make space for new recording.
 - Check if the recording conflicts with another channel. Stop the current recording or wait until the recording is finished.
 - Check that the product is switched on when the recording starts.
- 13. Cannot operate Time Shifted Recording. (PVR only)**
- TSR may not be available during recording. Wait until the recording is finished.
 - Delete unnecessary programs and make space for new recording.
- 14. Cannot playback. (PVR only)**
- To playback the recorded file of a scrambled channel, use the Smartcard. If it has been a long time since you last recorded, this may not work. Contact the customer service centre.
 - The signal during recording may be weak or the hard disk may be full.
- 15. Cannot change channels while recording. (PVR only)**
- Certain channels may not be changed due to restriction of the tuner or connection type.

HUMAX Customer Support

More information on your product is provided in the HUMAX website. Should your product require warranty service, please contact the following to obtain the appropriate authorization.

HUMAX Italia	Tel:	+39 199 309 471
	Website:	www.humaxdigital.com/italy
	E-mail:	servizioclienti@humaxdigital.com
	Humax Srl:	Via Brescia 28 20063 Cernusco S/N (MI) Fax. +39 02 99765669

Note: For hardware repair, please visit our website.

Error Messages

Error messages	Possible causes	What to do
No or bad signal [Satellite]	The satellite dish is not pointing at the satellite.	Adjust the dish alignment.
	Signal is too weak.	Increase the LNB voltage or connect a signal amplifier.
	Satellite dish is too small.	Change to a larger dish.
	Problem with LNB	Change the LNB.
	Wrong antenna setting	Set the antenna correctly.
No or bad signal [Cable]	The cable is not connected.	Make sure the cable is connected correctly.
	The cable may be damaged or defective.	Replace the cable.
	The channel is not broadcasting.	Replace the cable.
No or bad signal [Terrestrial]	The aerial is not pointing correctly.	Adjust the aerial. Check the cable from the aerial. If you cannot resolve the problem, request a professional to test your aerial installation.
The channel is scrambled or not available.	The channel has a signal but no audio or video.	Check if the channel is currently on air.
	The channel has been deleted by the broadcasting company.	Check if the channel is currently on air.
	The channel is for data broadcasting.	Remove the channel from the channel list and check for new transponder details.
The audio is not available.	The channel has a video signal but no audio.	Press the audio button to confirm that the channel has audio options.

Error messages	Possible causes	What to do
No access	No access	Make sure you have a subscription to the channel.
	No authorisation	If the product has been in standby or power off for a long time, please wait for authorisation. It may take up to 60 minutes.
No card inserted	Smartcard is not inserted.	Insert the Smartcard.
Incorrect card	Wrong Smartcard is inserted.	Insert the correct Smartcard.
	Smartcard is not inserted correctly.	Remove the Smartcard and reinsert it.
	Smartcard is damaged.	Contact your Smartcard retailer or channel broadcaster and ask for replacement.
CI-Module not installed	CI-Module not installed	Insert the CI-Module.
	CI-Module is not inserted correctly.	Remove the CI-Module and reinsert it.
	CI-Module is not recognised.	Insert another CI-Module to check if the current one is working.
Invalid CI-Module	Wrong CI-Module	Insert the correct CI-Module.
	CI-Module is damaged.	Replace the CI-Module.
The antenna cable is short-circuited. [Satellite]	LNB cable is short.	Replace the LNB cable.
	LNB is internally short.	Replace the LNB.
	Alien substance is inserted into the LNB IN port. The port may be damaged.	Remove the alien substance and contact the service centre if the port is damaged.

Using the Universal Remote Control

Setting the Universal Remote Control

Set up the universal remote control so that you can control your TV with this universal remote control.

1. Select the mode (PVR, TV, DVD, AUDIO) you want to set by pressing the corresponding button on the remote control. The button will blink once.
2. Keep pressing the button for 3 seconds until the button lights on.
3. Enter the 3-digit code. Every time a number is entered, the button will blink. When the third digit is entered, the button will blink twice.
4. If a valid 3-digit code is entered, the product will power off.
5. Press the **OK** button and the mode button will blink three times. The setup is complete.
6. If the product does not power off, repeat the instruction from 3 to 5.

Note:

- When no code is entered for 20 seconds, the universal setting mode will switch to normal mode.
- Try several setting codes and select the code that has the most functions.

Setting the Code Randomly

1. Select the mode (PVR, TV, DVD, AUDIO) you want to set by pressing the corresponding button on the remote control. The button will blink once.
2. Keep pressing the button for 3 seconds until the button lights on.
3. Press the [PAGE+/CH+] or [PAGE-/CH-] key randomly until the mode button blinks.
4. When the valid 3-digit code is found, the mode button will blink twice and the product will power off.
5. Press the **OK** button and the mode button will blink three times. The setup is complete.

6. If the product does not power off, repeat the instruction from 3 to 5.

Finding Out the Code

You can find out the 3-digit code of the TV universal code that is active.

1. Select the mode (PVR, TV, DVD, AUDIO) you want to set by pressing the corresponding button on the remote control. The button will blink once.
2. Keep pressing the button for 3 seconds until the button lights on.
3. Press the **INFO** button.
4. The 3-digit code number will blink starting from the 3rd digit.

Button	TV	DVD	AUDIO
STANDBY	POWER	POWER	POWER
	MUTE	MUTE	MUTE
PVR			
TV			
DVD			
AUDIO			
1	DIGIT 1	1	INPUT 1
2	DIGIT 2	2	INPUT 2
3	DIGIT 3	3	INPUT 3
4	DIGIT 4	4	INPUT 4
5	DIGIT 5	5	INPUT 5
6	DIGIT 6	6	INPUT 6
7	DIGIT 7	7	INPUT 7
8	DIGIT 8	8	INPUT 8
9	DIGIT 9	9	INPUT 9
0	DIGIT 0, 11	0	INPUT 0
TV Portal			
MENU	MENU	MENU	MENU/MODE
►	TEXT EXPAND	PLAY	PLAY
II	TEXT HOLD	PAUSE	PAUSE

■	PIP INPUT	STOP	STOP
●	PIP MOVE	RECORD, OPEN CLOSE	RECORD
◀◀	PIP OFF	REWIND, SEARCH REVERSE; SCAN	DVD SEARCH REW, CD SEARCH REW, REW
▶▶	PIP	FAST FORWARD, SEARCH FORWARD; SCAN	FAST FORWARD, DVD SEARCH REW, CD SEARCH REW, REW
◀◀	TEXT MIX	SKIP -, TRACK -, CHAPTER -	DVD SKIP -, CD SKIP -, SKIP -
▶▶	TEXT OFF, TV	SKIP, TRACK +, CHAPTER +	DVD SKIP+, CD SKIP +, SKIP +
RED	RED	RED	RED
GREEN	GREEN	GREEN	GREEN
YELLOW	YELLOW	YELLOW	YELLOW
BLUE	BLUE	PROGRAM	BLUE
MEDIA			
GUIDE	GUIDE	GUIDE	DSP MODE
OK	OK	OK	OK
UP	UP	UP	UP
LEFT	LEFT	LEFT	LEFT
RIGHT	RIGHT	RIGHT	RIGHT
DOWN	DOWN	DOWN	DOWN
EXIT	EXIT	EXIT, RETURN	EXIT
BACK	LAST, RECALL; PP; LAST CHANNEL	CLEAR	REPEAT
VOL+	VOL+	VOL+	VOL+
VOL-	VOL-	VOL-	VOL-

Appendix

	INFO, OSD; DISPLAY	INFO, OSD; DISPLAY	INFO
LIST	Channel list	LIST	
P+	P+	P+	P+
P-	P-	P-	P-
TEXT	TEXT	PVR MENU	
		AUDIO, LANGUAGE	SURROUND
SUB	SUBTITLE, LANGUAGE; CC	SUBTITLE	
TV/RADIO	TV/DTV ATV/ DTV; D/A; DTV/TV; DTV; DIGITAL	HDD, DVD/ HDD	BAND
	TEXT SUBPAGE TEXT TIME		RANDOM
	TEXT INDEX	TITLE	
	TEXT POSITION TEXT CANCEL; TEXT UPDATE	SLOW; STEP	
SOURCE	SOURCE, AV, 5SINPUT; TV/AV	SOURCE, TV/DVD, TV/DISK	SOURCE, FUNCTION
V-FORMAT	TEXT SIZE; TEXT EXPAND; FTB		
DUAL VIEW	DUAL VIEW		
MHP	MHP INFO		
SEARCH	SEARCH		
AGENDA	SCHEDULED PROGRAM		
REC LIST	SCHEDULED RECORDING		

Brand	Code
Acer	261, 278, 305
Acoustic Solutions	210, 312, 324, 370, 386, 428, 477
Akai	102, 006, 098, 144, 145, 111, 061, 043, 074, 148, 232, 280, 128, 122, 461, 109, 462, 489, 094, 084, 083, 065, 035, 034, 033, 028, 023, 011, 004, 002, 154, 321
Alba	006, 144, 134, 204, 087, 064, 036, 005, 108, 473, 455, 447, 388, 099, 084, 077, 072, 065, 059, 034, 023, 002
Bang & Olufsen	014
Beko	006, 144, 086, 145, 111, 064, 072, 172, 361, 405
BenQ	223, 328, 329
Black Diamond	444, 204, 211
Brionvega	006, 014, 062
Bush	102, 006, 144, 134, 204, 138, 087, 061, 043, 036, 005, 108, 376, 373, 370, 361, 355, 352, 327, 388, 430, 431, 432, 440, 448, 451, 473, 476, 477, 478, 002, 033, 035, 044, 045, 056, 059, 065, 066, 095, 133, 164, 210, 213, 229, 232, 250
cello	397, 410, 418, 419, 420
Crown	006, 144, 134, 204, 086, 145, 087, 111, 143, 064, 361, 135, 072, 071, 053, 033, 002
Daewoo	102, 006, 124, 444, 036, 441, 406, 341, 338, 271, 249, 195, 192, 190, 164, 133, 119, 091, 079, 066, 035, 034, 002
Dell	235, 278
DMTech	260, 438, 449, 454, 456
Ferguson	006, 120, 098, 103, 030, 204, 012, 020, 029, 046, 052, 054, 077, 292, 447, 476
Finlux	102, 006, 144, 145, 333, 327, 172, 122, 118, 094, 089, 084, 083, 070, 055, 035, 023, 018, 017, 014, 011, 010
Fujitsu	002, 011, 032, 035, 042, 137, 173, 187
Fujitsu General	002, 032, 035, 137
Fujitsu Siemens	172, 211, 230, 246, 268, 369
Funai	144, 134, 043, 275, 336, 369, 407
GoldStar	006, 144, 145, 111, 061, 001, 007, 020, 023, 027, 034, 035, 047, 067

Gooding	087
Goodmans	102, 006, 120, 144, 103, 134, 124, 444, 204, 087, 043, 036, 005, 478, 211, 232, 477, 250, 476, 271, 445, 355, 370, 373, 440, 376, 382, 383, 386, 002, 004, 011, 035, 047, 052, 054, 065, 066, 084, 091, 094, 119, 121, 133, 172, 195, 210
Graetz	144, 087, 061, 023, 053, 065, 211
Grundig	102, 006, 030, 087, 142, 005, 108, 498, 476, 448, 447, 445, 430, 405, 370, 271, 267, 250, 225, 135, 121, 010, 101, 096, 028, 077
Grunkel	211
Hannspree	262, 263, 264, 342, 401, 402, 463
Hantarex	006, 002, 094, 190, 260, 289
Hinari	006, 043, 036, 005, 002, 033, 059, 077, 443
Hisense	102, 092, 165, 254, 265, 366, 491
Hitachi	006, 098, 124, 204, 208, 005, 019, 037, 146, 152, 153, 163, 169, 193, 197, 007, 206, 210, 217, 227, 295, 296, 330, 377, 399, 424, 483, 020, 021, 023, 027, 035, 054, 056, 060, 076, 081, 083, 084, 085, 089, 091, 094, 018, 106, 107, 011
Humax	505, 299, 506, 507, 245, 319, 322, 411, 433, 479
Hyundai	164, 190, 192, 241, 244, 271, 291, 317, 338, 340, 341, 439
Inno Hit	036, 002, 011, 035, 045, 047, 094, 211
Irradio	006, 036, 002, 047, 065, 147
JVC	111, 036, 005, 129, 130, 015, 029 065, 072, 137, 149, 207, 264, 362 408, 496
Keymat	258, 300, 398, 436, 437
Lenoir	002, 214
LG	102, 006, 144, 145, 138, 061, 064, 248, 281, 354, 367, 368, 384, 396, 416, 417, 425, 426, 215, 209, 067, 047, 035, 034, 027, 023, 002, 001, 236, 257
Loewe	006, 064, 014, 048, 093, 094, 123 131, 167, 414, 434
Logik	204, 001, 003, 029, 162, 195, 224, 292, 376, 464, 465, 466

Appendix

Logix	134, 095
Luxor	098, 204, 061, 023, 033, 035, 047, 055, 056, 060, 083, 084, 122, 211
Manhattan	006, 134, 204, 164, 192, 237, 293
Marantz	102, 006, 071, 140, 277, 317
Marks and Spencer	420
Matsui	102, 006, 144, 030, 204, 087, 005, 080, 074, 153, 195, 097, 094, 369, 445, 077, 447, 065, 059, 056, 052, 044, 035, 033, 028, 011, 008, 004, 003, 002
Mitsubishi	102, 006, 204, 005, 019, 014, 015, 027, 093, 096, 191, 311
Mivar	034, 035, 047, 048, 094, 112
NEC	005, 002, 003, 025, 035, 040, 049, 066, 140, 239, 379
Nokia	098, 113, 111, 061, 023, 033, 049, 053, 055, 056, 066, 083, 084, 089, 122
Nordmende	006, 144, 103, 030, 020, 046, 054, 242, 280, 499
Onida	207, 226
Orion	102, 006, 144, 204, 467, 458, 457, 456, 448, 445, 443, 385, 218, 195, 131, 097, 094, 077, 071, 059, 050, 049, 003
Online	006, 036
Ormond	134, 204
Orsowe	094
Pacific	102, 144, 204, 208, 077, 256
Packard Bell	254, 293
Panasonic	006, 098, 061, 129, 038, 023, 063, 094, 187, 251, 294, 353, 359, 279, 306
Panavision	006, 070
Philco	006, 064, 014, 021, 072
Philips	102, 006, 061, 459, 435, 429, 395, 310, 302, 297, 247, 125, 110, 101, 073, 066, 054, 029, 014, 002
Phonola	102, 006, 014, 029, 034
Pioneer	006, 086, 061, 064, 020, 023, 024, 046, 073, 093, 136, 159, 233, 277, 286, 381
Pionier	086, 064, 327
Radiomarelli	006, 014, 094

Relisys	190, 192, 193, 194, 220, 221, 271, 310, 333, 338, 341, 355, 390
Saba	120, 098, 144, 103, 061, 014, 020, 023, 046, 052, 054, 090, 094, 335
Sagem	113, 080, 182, 253, 337
Samsung	102, 006, 043, 064, 108, 115, 231, 252, 276, 287, 332, 345, 350, 351, 372, 442, 474, 488, 490, 492, 228, 176, 175, 127, 095, 047, 035, 034, 033, 027, 023, 011, 009, 002
Sanyo	204, 064, 005, 019, 442, 370, 363, 358, 357, 356, 222, 200, 150, 140, 097, 053, 048, 035, 034, 033, 025, 023, 017, 011, 008, 003, 002, 240
Schaub Lorenz	098, 144, 086, 111, 061, 056, 066, 215, 256, 267
Schneider	102, 006, 144, 134, 204, 061, 208, 036, 451, 450, 293, 128, 097, 095, 065, 056, 054, 042, 035, 023, 010
SEG	006, 134, 204, 087, 043, 036, 005, 285, 211, 210, 119, 062, 056, 035, 034, 002
Sei-Sinudyne	006, 014, 032, 094, 097
Seleco	023, 032, 042, 055, 062, 065, 070, 075, 099
Sharp	005, 130, 216, 015, 029, 088, 094, 177, 274, 334, 365, 409, 166, 288
Siemens	006, 030, 028, 096, 101
SKY	006, 195, 271, 300, 307, 308, 340, 341, 342, 343, 344, 391, 400, 421
Sonoko	006, 043, 002, 035, 045
Sony	006, 301, 005, 446, 412, 393, 375, 360, 325, 255, 203, 185, 174, 058, 003
Strong	210, 211
Technika	422, 428, 465, 468, 480, 493
TechniSat	102, 131, 237
Technisson	144, 242, 361
Technosonic	102, 120, 091, 195, 256, 258, 436, 437, 451, 468
Telefunken	006, 120, 144, 103, 086, 320, 202, 105, 090, 082, 055, 054, 052, 046, 020, 016, 012, 348
Tevion	102, 006, 144, 134, 204, 208, 468, 405, 403, 376, 355, 327, 298, 246, 242, 232, 230, 172, 128

Thomson	006, 120, 103, 020, 046, 052, 054, 056, 082, 335
Toshiba	030, 204, 005, 115, 129, 092, 447, 364, 313, 304, 242, 212, 211, 183, 100, 039, 022, 020, 010, 009, 004, 236, 257
Tosumi	451
Vestel	006, 134, 204, 035, 211, 333, 370
Videocon	092
Viewsonic	307, 308, 323, 335, 349, 391, 394, 259, 331
Wharfedale	102, 006, 095, 189, 256, 327, 370, 452, 453, 477, 502
Yamaha	169, 314, 330, 184
Zanussi	032, 035
TV/VCR Combo	
Aiwa	445
Amstrad	026
Beko	086
Daewoo	444, 119
GoldStar	006
Grundig	102, 006, 030, 101, 445
Irradio	147
LG	027
Philips	102, 006
Saba	120
Samsung	442
Sanyo	442
Sharp	015
Thomson	120
United	445
TV/VCR/DVD Combo	
Grundig	448
Orion	448

If the code for your equipment is not listed, visit the following website and see **MDB1.3** for a complete list of supported codes.
<http://www.humaxdigital.com/global/support/rucodelist.asp>

MANUAL/HDR1001S/100IT



20000-00413

