

Operation Manual

Humax STE1000BSW

2.1Ch Slim & Stylish Soundbar



HUMAX

● Welcome to Humax Audio

Thank you for purchasing this Humax product.

This manual will provide operation instructions and safety information please follow carefully so that you can enjoy many hours of audio pleasure.

General Information

- + Humax is the trademark of Humax Co.Ltd.
- + This manual has the copyright of Humax Co.Ltd and it is prohibited to distribute the whole or the part of the manual without notice.
- + This manual was written on the basis of present product specifications. Each and every example original which is written, tables and example photos, detailed function of the product and hardware & software specs can be changed with no special prediction.
- + The information in this User operation manual is subject to change without notice.

B-class device (home broadcasting communication device)

This product is an electronic goods that have registered electronic wave suitability for home use, and it is mainly used at homes and can be used in any region.

1. Model name: STE1000BSW
2. Company name certified: Humax Co.Ltd.
3. Produced date: Written on the product box
4. Manufacturer/Manufacturing country: Humax Co.Ltd. / Republic of Korea

- Package components

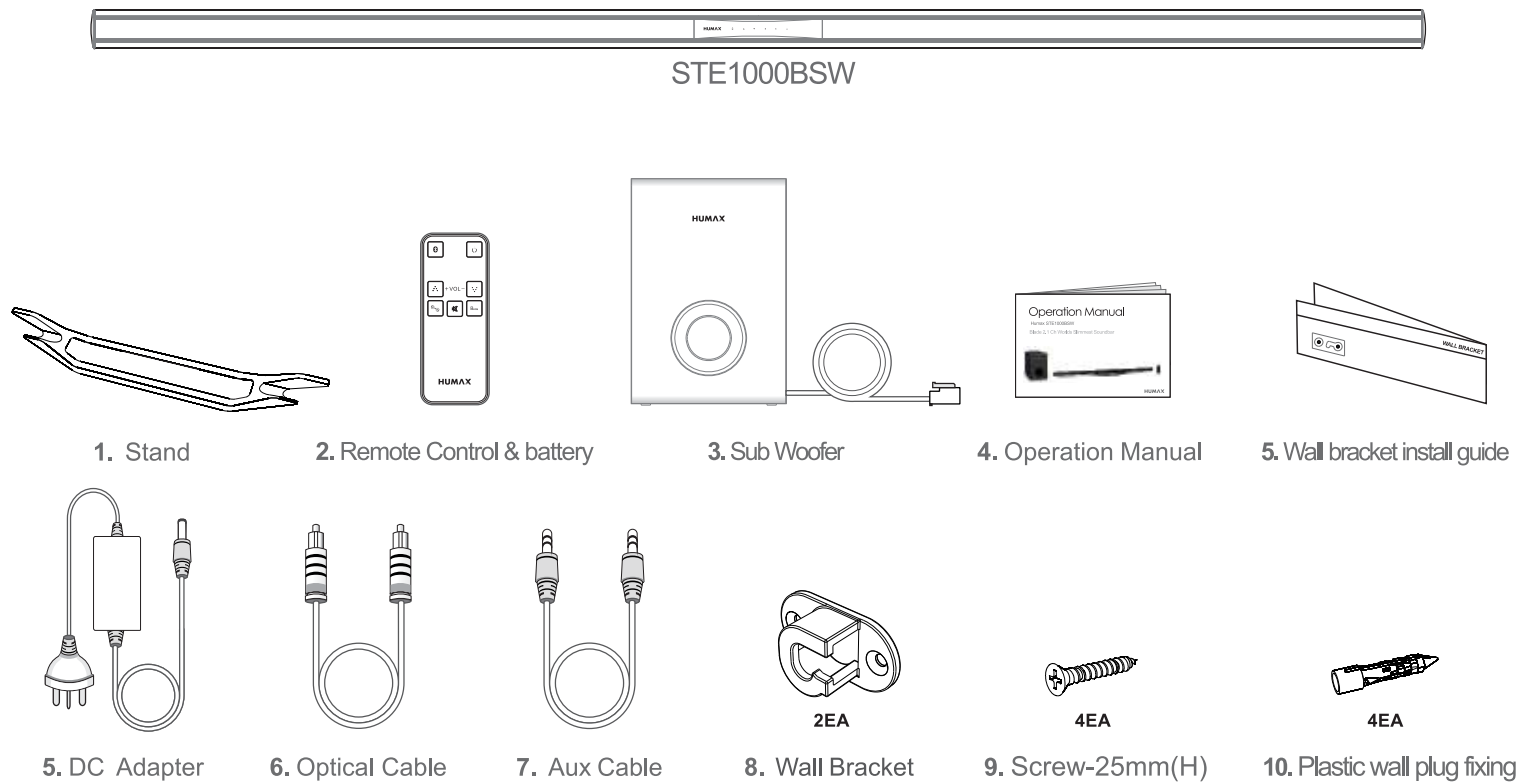

+ Check the enclosed accessories inside package.

+ Images are for illustration purposes only.

● Touch Keys and function

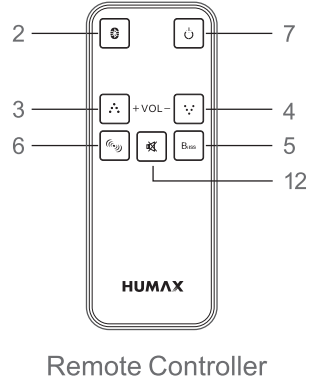
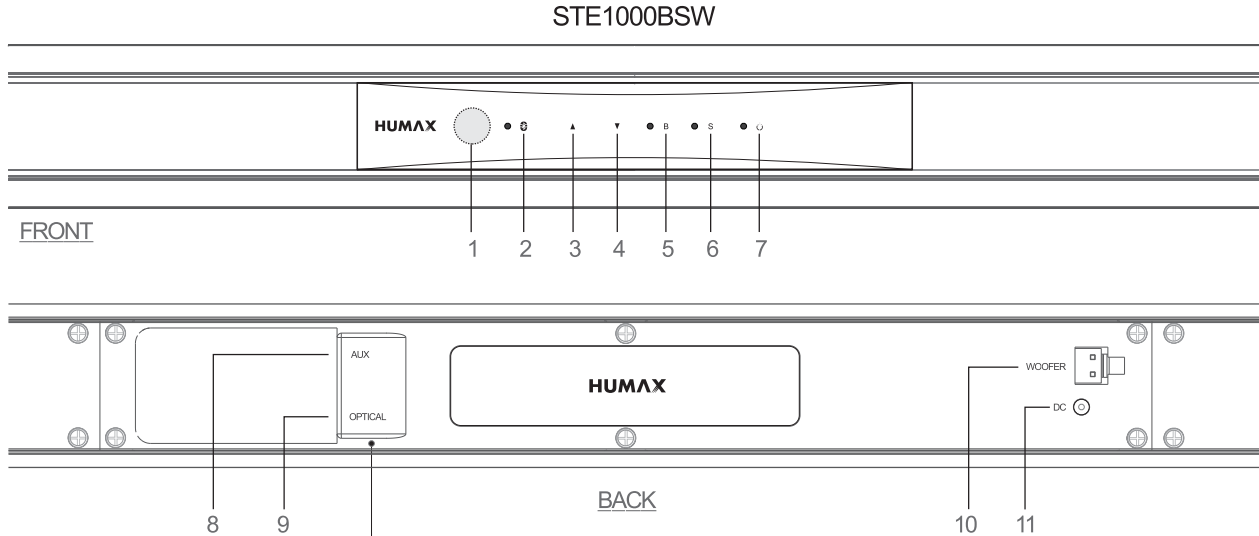

● Connections

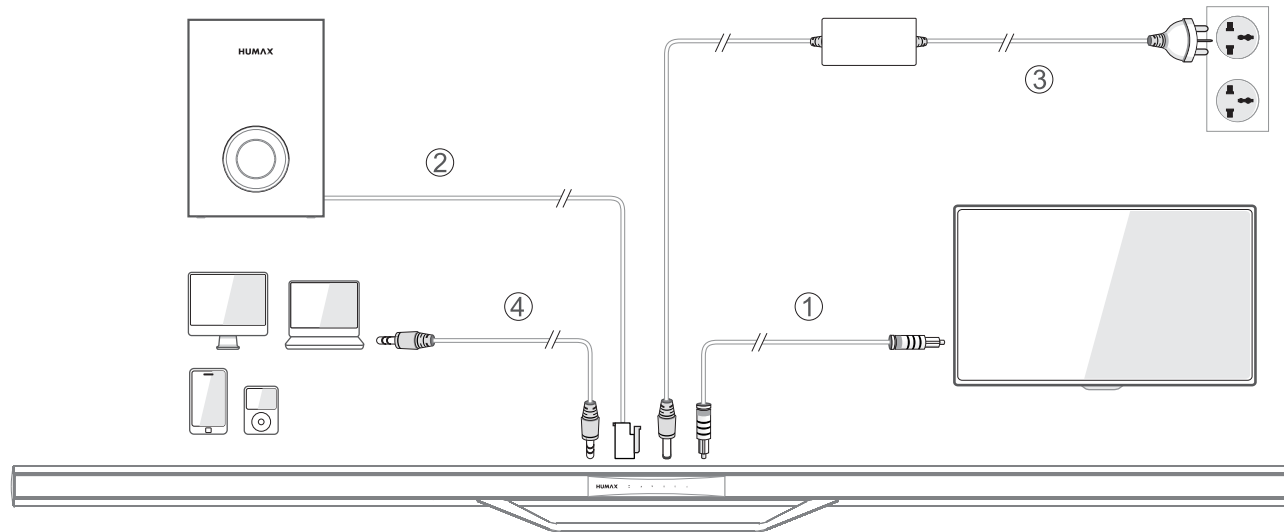

- ① TV Connection: Connect the "Optical cable" supplied to the Digital Audio Out (Optical / SPDIF) connection of your TV or STB to the Optical connection of your Humax Soundbar.
- ② Sub Woofer Connection: Connect the "Woofer Cable Jack" to the "Woofer" connection of your Humax Soundbar.
- ③ Power Connection: Connect the "DC Adapter Jack" to the "DC" connection of your Humax Soundbar.
- ④ If your TV set does not have a Optical connection please connect the "AUX cable" supplied to the "AUX" connection of your Humax Soundbar to the TV set.

* Note: please only use one connection to your TV set, Optical or AUX; if you connect both connections the AUX connection will take precedence.

* Warning: Only Power On the Humax Soundbar after all of the require connections above are connected.

- LED Indicator

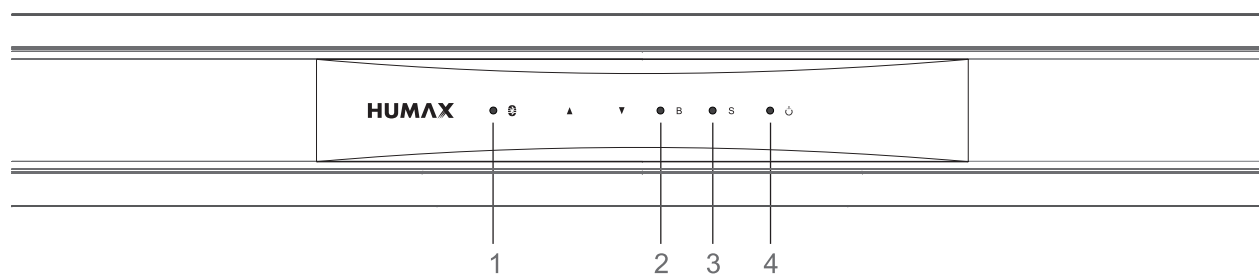

LED color	Motion frequency	Function
1. Blue	Blinked continuously	Bluetooth Pairing mode
Blue	Turned on continuously	Bluetooth operation mode
2. Green	Turned on continuously	Bass Booster
3. Orange	Turned on continuously	Surround Mode
4. Red	Turned on continuously	Power on
Red	Blinked once	Volume Up, Down
Red	Blinking continuously	Mute has been pressed

- Bluetooth connection methods

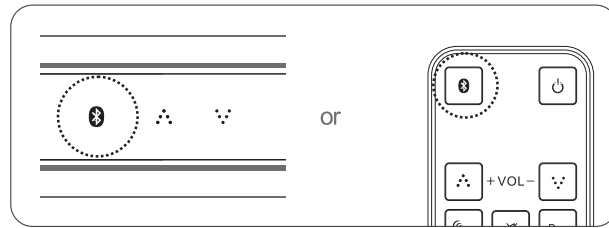

Press the "Pairing mode" button on the remote control or on the control panel of the Humax Soundbar.

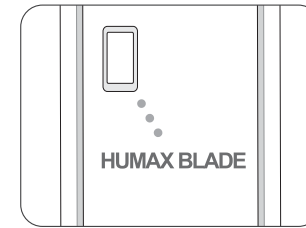

Turn on "Bluetooth" of Phone/Notebook Select Bluetooth ID "HUMAX BLADE" on Phone/Notebook in "Bluetooth Device Searching Mode".

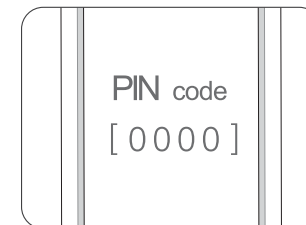

Pairing PIN code is '0000'.

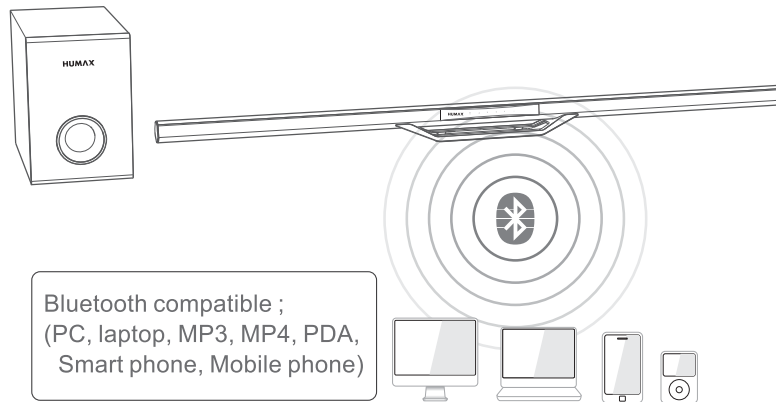

Bluetooth compatible ;
(PC, laptop, MP3, MP4, PDA,
Smart phone, Mobile phone)

After pairing is completed the LED will stay Blue on the control panel of the Humax Soundbar.

If requested the Pairing PIN Code is "0000"

- Product Specification

	STE1000BSW
Impedance	8 ohm
Frequency Range	40Hz ~ 14KHz
Sound Pressure Level	90dB ± 3dB
Speaker System	160W(Front 60W x Sub Woofer 100W)
Sound Effect	Bass Booster / Surround
Connectivity	Wireless : Bluetooth 3.0 / Wire : Optical Cable, AUX Cable
In-put	Optical cable(1) / AUX(1) / Power Supply(1)
Out-put	AV Jack(1) to Sub Woofer
Adapter In-put	100 - 240V ~ 50/60Hz
Adapter Out-put	DC 18V 3.0A
Dimension	Front : 1000(W) x 44 (H) x 20(D) mm, Sub Woofer : 195(W) x 266(H) x 265(D) mm
Remote Controller	○
Color	● Black
Operating ambient temperature	-20° to 40° C

Note: The specifications are subject to change without notice.

Troubleshooting

Before contacting us for help please check the following useful information to resolve any issues you may be experiencing:

No Sound / Distorted Sound

- No audio coming from the soundbar.

- Check that the cable (Optical or AUX) is connected correctly between the soundbar and the TV set
- Check that the soundbar is powered on (RED light)
- Check that the neither the soundbar or the TV are on Mute and the volume is turned up
- Check the Audio settings on your TV and if required change the audio output to PCM or Stereo
- Check that you do not have a Bluetooth device connected as this will take priority over the other connections
- If connected via Optical cable, connect the soundbar to your TV using the AUX cable

- No Power / Soundbar not switching on.

- Check that the mains cable is connected to the AC Adapter, when powered there is a blue light on the AC Adapter
- Check that the cable from the AC Adapter to the soundbar is connected correctly
- Check that the soundbar is powered on, either using the power button on the remote or touching the power button on the soundbar control panel
- When powered up the power button on the soundbar control panel will be red.

Remote control is not working

- Check that the battery inserted correctly
- Use the remote in a direct line with the soundbar, so nothing is obstructing it
- Change the battery in the remote control

Can I connect multiple items to the soundbar?

- Multiple items can be connected however the soundbar will output audio in the following priority order:
 1. Bluetooth - when paired with a device this will take priority over any other connected devices
 2. AUX
 3. Optical

Note: If you have a TV connected or multiple devices connected with Optical and AUX then AUX will always be outputted.

If you wish to use Optical please remove the AUX cable from the soundbar.

I cannot find the Humax soundbar when trying to connect via Bluetooth.

- Check that the Bluetooth is switched on by press the Bluetooth button on the remote or soundbar control panel
- Check that the Bluetooth light is flashing blue continuously (if no devices have been paired) or is constantly blue when a device is paired and connected
- When searching for the soundbar it will appear as "Humax Blade" on your Device List
- If prompted for a password / Pin code to pair the Bluetooth device please enter 0000
- If the soundbar is already listed as Paired please remote / un-pair the device and try pairing again

Service and Support

Information concerning troubleshooting, software upgrade and product support is provided in the following websites and call centers. Should your product require warranty service, please contact HUMAX to obtain the appropriate authorisation.

HUMAX Call Centre

Tel: 0344 318 8800
Opening Hours: Mon - Fri 09:00 – 17:30 (excluding Bank Holidays)
Email: uksupport@humax-digital.co.uk
Website: www.humax-digital.co.uk
Language: English

HUMAX Warranty

Humax warrants this product to be free of defects in material and workmanship subject to conditions set below.

CONDITIONS

- In the event that this product fails to function properly during the 12 month warranty period, Humax will make this product capable of operating for the purpose of which it was designed, without charging for labour and parts.
- This warranty will be honoured only if a valid receipt or proof of purchase is presented confirming the date and retailer of purchase. Humax reserves the right to refuse repairing the product if the above document is not available or the information is not complete or illegible.
- This warranty does not cover shipping or transportation charges from you to us.
- The obligations of the distributor are limited to the repair of defect parts.
- Costs and risks of transport to the retailer as well as removal and installation of the product, and any other costs directly or indirectly related to its repair, are not covered by the warranty.
- All warranty repairs performed by non-authorized repair shops will not be reimbursed and if such repairs damage this product such damage will not be covered by this warranty.
- This warranty is not applicable in cases other than defects in materials or workmanship and, in particular, does not cover:
 - a) periodic check-ups, adjustments, maintenance or conversions as well as replacement of parts due to normal wear and tear;
 - b) damage caused by accidents, negligence, modifications, use of non-HUMAX parts, improper use, installation or package;
 - c) damage caused by lightning, water, fire, acts of war, public disturbances, incorrect mains voltages, incorrect ventilation or any other cause beyond the control of the distributor.
 - d) products where the label bearing the serial number has been removed, defaced or is illegible.

HUMAX's maximum liability shall not exceed the actual purchase price paid by you for the product. In no event shall HUMAX be liable for special, incidental, consequential or indirect damages.

EU regulatory conformance

Hereby, HUMAX Co., Ltd, declares that this STE1000BSW is in compliance with the essential requirements and other relevant provisions of Directive 1999/5/EC. The product carries the CE mark applied onto it.



The Declaration of conformity made under EC Directives and is available for viewing at the following location in the EU community:
<http://www.humaxdigital.com/global/support/support.html>

Wireless equipment use information

1. In France
Authorization for outdoor usage is limited to Channels 1~7 (2.400 ~ 2.454 Ghz).
2. In Italy
For outdoor usage a general authorization is required from the national spectrum authorities.
3. In Latvia
For outdoor usage an authorization is required from the Electronic Communications Office.
4. 5GHz Radio Local Area Networks (RLANs) Band only indoor use.

Safety Warning

This product has been manufactured to comply with international safety standards. Please read the following safety precautions carefully.

Safety Instructions and Precautions

1. MAINS SUPPLY

Operate this product only from the type of power supply indicated on the marking label. If you are not sure of the type of power supplied to your home, consult your local power company.
Disconnect the product from the mains before you start any maintenance or installation procedures.

2. OVERLOADING

Do not overload a wall outlet, extension cord or adapter as this may result in electric fire or shock.

3. LIQUID

The product should not be exposed to liquid of any kind. In addition, no objects filled with liquid should be placed on the apparatus.

4. CLEANING

Disconnect the product from the wall outlet before cleaning.
Use a light damp cloth (no solvents) to dust the product.

5. VENTILATION

The slots on top of the product must be left uncovered to allow proper airflow into the unit.
Do not stand the product on soft furnishings or carpets.
Do not stack electronic equipment on top of the product.

6. ATTACHMENTS

Do not use any unsupported attachments as these may be hazardous or cause damage to the product.

7. LIGHTNING, STORM OR NOT IN USE

Unplug the product from the wall outlet and disconnect the antenna during a thunderstorm or when left unattended and unused for long periods of time. This will prevent damage to the unit due to lightning and power-surges.

8. EXTRANEIOUS OBJECTS

Do not insert anything through the openings in the unit, where they can touch dangerous voltage points or damage parts.

9. REPLACEMENT OF PARTS

When replacement of parts is required, be sure the service technician uses replacement parts specified by the manufacturer or those that have the same characteristics as the original part. Unauthorized substitution may result in additional damage to the unit.

Installation Guide

HOW TO INSTALL SOUNDBAR ON THE WALL

Before mounting soundbar on the wall ,
Please plug in all cables connected tightly.
Please refer to below installation guide.

Warning!

When the soundbar mounted on wall,
it may cause product damaged,,,

- Do not fix soundbar upside down.
- Do not place something on soundbar mounted on the wall
- Please fix soundbar tightly not to be dropped down.
- Please keep children not to shake soundbar or hang something on it.

Necessary Accessories



SOUNDBAR

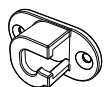

2EA

Wall Bracket



4EA

Screw-25mm(H)



4EA

Plastic wall plug fixing

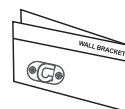

Wall Bracket Install Guide

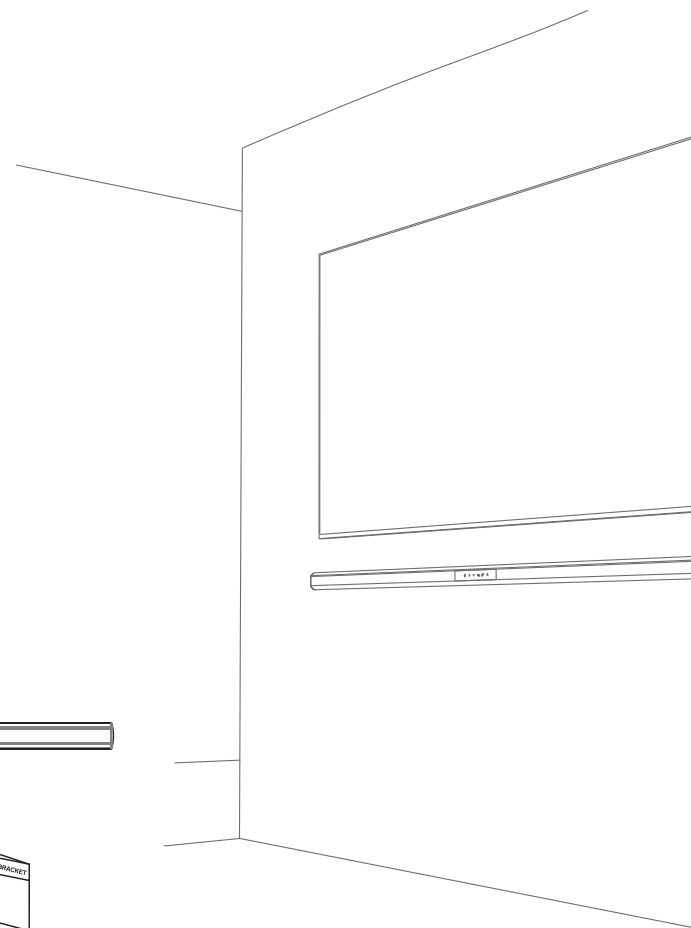

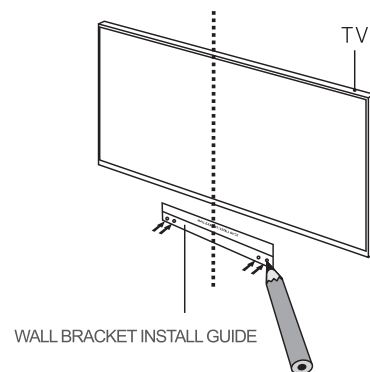

1. Please keep "WALL BRACKET INSTALL GUIDE" with center position of Television horizontally
Please mark screw position of Wall Bracket" on "WALL BRACKET INSTALL GUIDE".

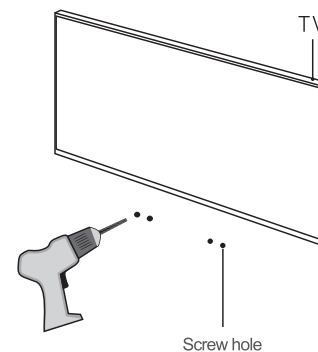

2. Please make holes for screws on wall by using drill.

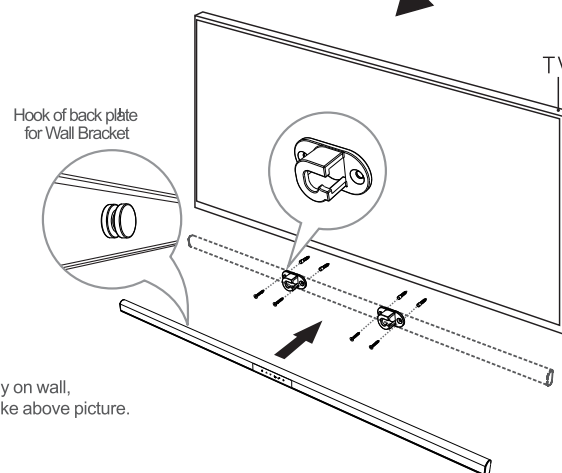

3. Please fix the screws and wall plugs enclosed tightly on wall,
Please mount hooks of back plate on wall bracket like above picture.

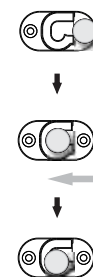

How to hook up Soundbar
on Wall Bracket

HUMAX



The product specifications may change without predictions for improvements of performances,
and the image within the manual may be somewhat different from the real product image.

Manuale dell'utente

Humax STE1000BSW

2.1Ch Slim & Stylish Soundbar



HUMAX

• Benvenuto in Humax

Grazie per aver scelto un prodotto Humax. Si prega di leggere attentamente il manuale, onde poter installare ed utilizzare correttamente la soundbar e mantenere al massimo le sue prestazioni.

General Information

- + Humax is the trademark of Humax Co.Ltd.
- + This manual has the copyright of Humax Co.Ltd and it is prohibited to distribute the whole or the part of the manual without notice.
- + This manual was written on the basis of present product specifications. Each and every example original which is written, tables and example photos, detailed function of the product and hardware & software specs can be changed with no special prediction.
- + The information in this User operation manual is subject to change without notice.

B-class device (home broadcasting communication device)

This product is an electronic goods that have registered electronic wave suitability for home use, and it is mainly used at homes and can be used in any region.

1. Model name: STE1000BSW
2. Company name certified : Humax Co.Ltd.
3. Produced date: Written on the product box
4. Manufacturer/Manufacturing country: Humax Co.Ltd. / Republic of Korea

- **Contenuto della confezione**



STE1000BSW



1. Supporto



2. Telecomando e batteria

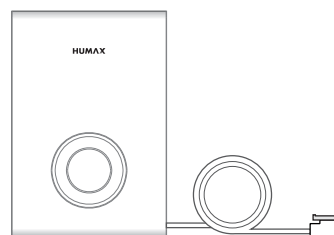

3. Sub Woofer



4. Manuale dell'utente

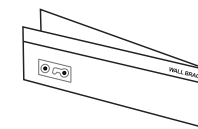

5. Linea guida per il
fissaggio a muro

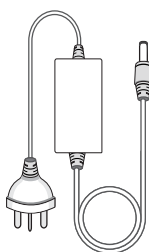

6. Alimentatore

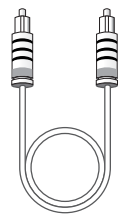

7. Cavo attico

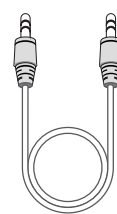

8. Cavo Aux

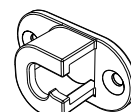

2EA

9. Supporto per
fissaggio a muro



4EA

10. Vite-25mm



4EA

11. Tassello in plastica

- + Controllare che i materiali elencati siano presenti all'interno della confezione
- + Le immagini sono a scopo illustrativo

- **Tasti sensibili al tocco e funzioni**

STE1000BSW

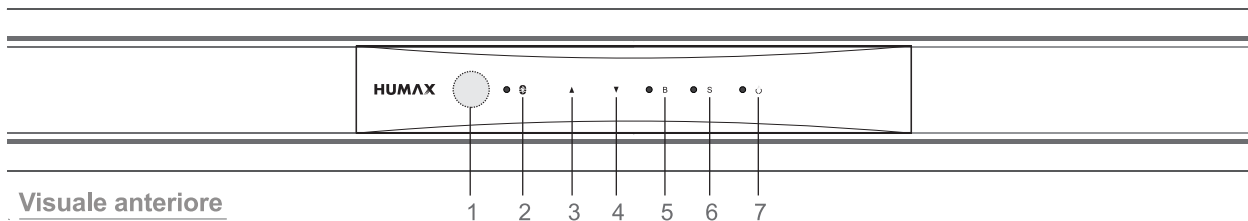

Visuale anteriore

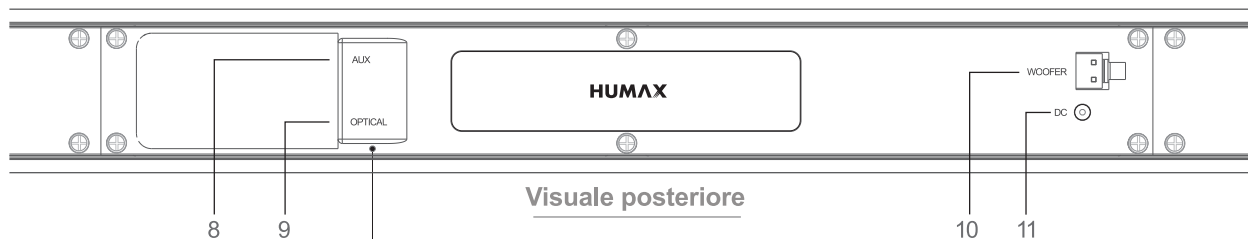

Visuale posteriore

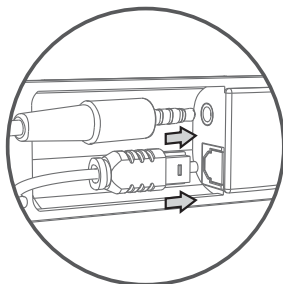

- | | |
|--------------------------------|---------------------------|
| 1. Ricevitore IR | 7. Power |
| 2. Accoppiamento via Bluetooth | 8. Uscita Aux |
| 3. Volume Su(+) | 9. Uscita ottica |
| 4. Volume Giù (-) | 10. Uscita Woofer |
| 5. Bassi | 11. Ingresso alimentatore |
| 6. Effetto surround | 12. Muto |

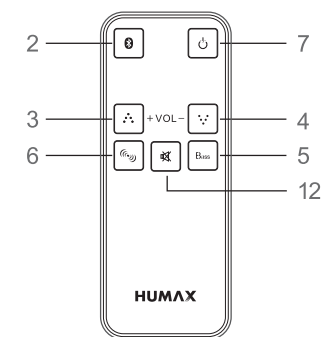

Telecomando

• Collegamenti

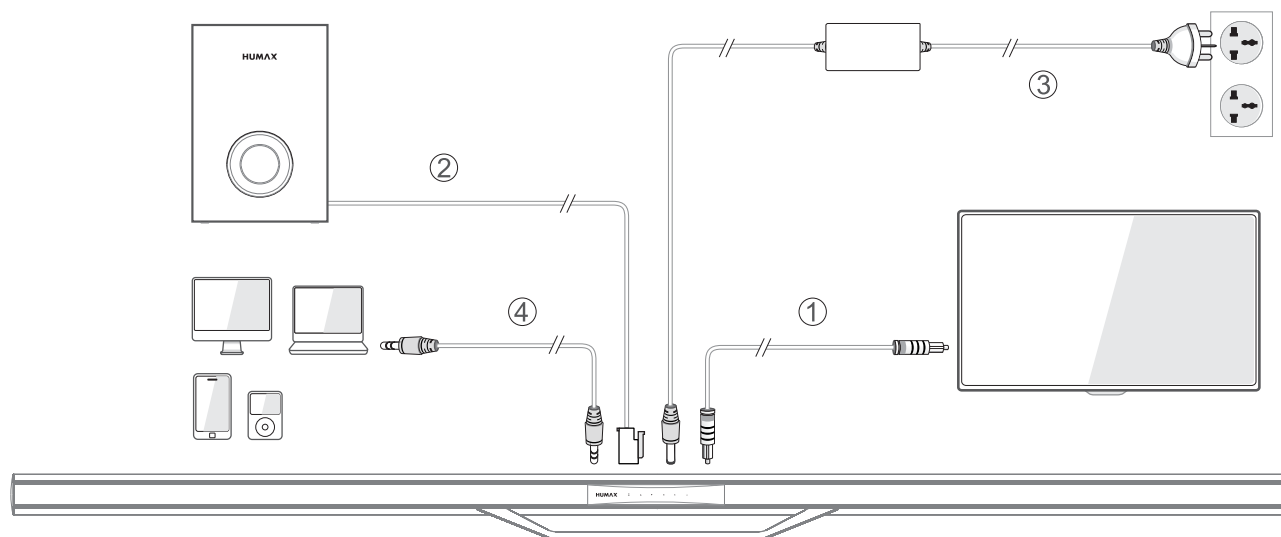

1. Cavo ottico: collegare la Humax Soundbar mediante il cavo S/PDIF(audio digitale) in dotazione ad una sorgente provvista di uscita audio digitale.
2. Collegamento del Sub Woofer: collegare il cavo del Sub Woofer alla presa "Woofer" dello Humax Soundbar
3. Cavo di alimentazione: collegare il cavo di alimentazione alla presa DC dello Humax Soundbar.
4. Se la sorgente è sprovvista di uscita audio digitale, si prega di collegarla all'ingresso AUX.

*Nota: si prega di utilizzare una connessione per volta. Se vengono collegati entrambi gli ingressi, il collegamento AUX avrà la precedenza.

*Attenzione: accendere lo Humax Soundbar solo dopo aver verificato che tutti i collegamenti siano corretti.

● Indicatori LED

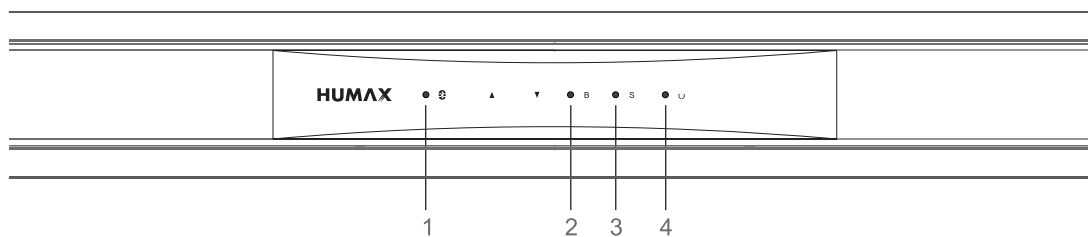

Colore LED	Frequenza	Significato
1. Blu Blu	Lampeggiante Sempre acceso	Accoppiamento di un dispositivo Bluetooth Riproduzione da dispositivo Bluetooth
2. Verde	Sempre acceso	Bass booster attivo
3. Arancione	Sempre acceso	Surround attivo
4. Rosso Rosso Rosso	Sempre acceso Un lampeggio Lampeggiante	Soundbar accesa Volume su/giù È stato premuto il tasto "Muto"

• Guida alla connessione Bluetooth

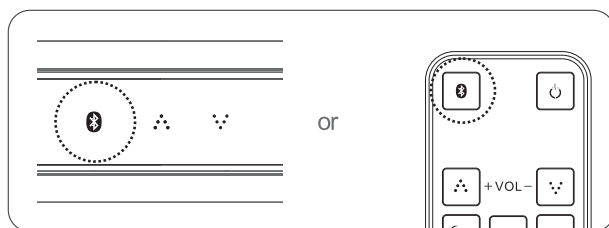

Premere il tasto "Accoppiamento via Bluetooth" dal telecomando o dal pannello di controllo dello Humax Soundbar.

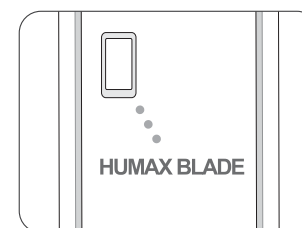

Accendere il Bluetooth del dispositivo sorgente e fare quindi una ricerca per trovare "HUMAX BLADE".

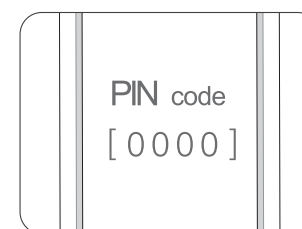

Se richiesto, il codice (PIN CODE) per accoppiare i due dispositivi è 0000.

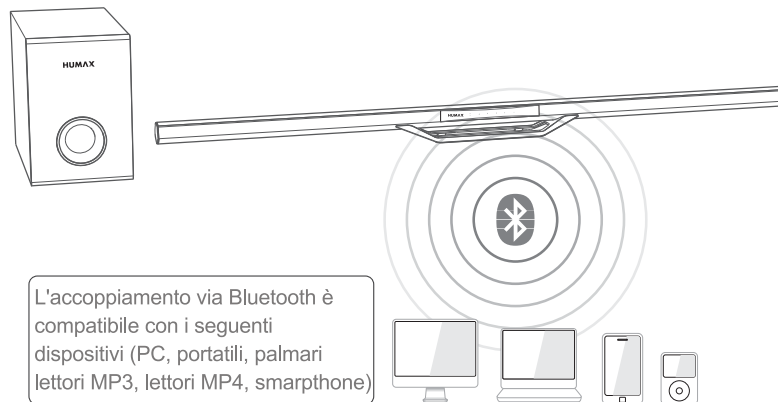

L'accoppiamento via Bluetooth è compatibile con i seguenti dispositivi (PC, portatili, palmari, lettori MP3, lettori MP4, smartphone)

Ad avvenuta associazione, il led blu sul pannello di controllo dello Humax Soundbar diventerà fisso.

- **Specifiche tecniche**

	STE1000BSW
Impedance	8 ohm
Frequency Range	40Hz ~ 14KHz
Sound Pressure Level	90dB ± 3dB
Speaker System	160W(Front 60W x Sub Woofer 100W)
Sound Effect	Bass Booster / Surround
Connectivity	Wireless : Bluetooth 3.0 / Wire : Optical Cable, AUX Cable
In-put	Optical cable(1) / AUX(1) / Power Supply(1)
Out-put	AV Jack(1) to Sub Woofer
Adapter In-put	100 - 240V ~ 50/60Hz
Adapter Out-put	DC 18V 3.0A
Dimension	Front : 1000(W) x 44 (H) x 20(D) mm, Sub Woofer : 195(W) x 266(H) x 265(D) mm
Remote Controller	○
Color	● Black
Operating ambient temperature	-20° to 40° C

Note: le specifiche sopra riportate potrebbero variare senza alcun preavviso.

Risoluzione dei problemi

Prima di rivolgersi all'assistenza, eseguire i controlli indicati di seguito:

+ L'audio non viene riprodotto.

- Controllare che il cavo (ottico o AUX) sia collegato correttamente tra lo Humax Soundbar e la sorgente
- Controllare che lo Humax Soundbar sia acceso (led rosso)
- Controllare che sia lo Humax Soundbar che il dispositivo sorgente non sia impostato su "Muto" e che il volume non sia basso
- Controllare le impostazioni audio del dispositivo sorgente e se possibile, cambiare l'uscita audio in PCM o Stereo
- Controllare che il dispositivo Bluetooth non sia connesso allo Humax Soundbar dato che questo ha la priorità massima sulle altre connessioni
- Se si sta utilizzando un cavo ottico, provare a collegare lo Humax Soundbar al dispositivo sorgente mediante un cavo AUX

+ Lo Humax Soundbar non si accende

- Controllare che lo Humax Soundbar sia collegato correttamente al suo alimentatore
- Controllare che lo Humax Soundbar si accenda sia mediante il tasto di accensione sul telecomando che con il tasto sul pannello di controllo
- Quando lo Humax Soundbar viene acceso, un led rosso si illuminerà

+ Il telecomando non funziona

- Controllare che le batterie siano state inserite correttamente
- Verificare che non ci siano particolari ostruzioni tra il telecomando e lo Humax Soundbar
- Cambiare le batterie del telecomando

+ È possibile collegare più di una sorgente allo Humax Soundbar contemporaneamente?

- Sì, è possibile ma bisogna sapere che lo Humax Soundbar potrà riprodurre solo una sorgente per volta e secondo questo ordine di priorità di connessioni:

1. Bluetooth - se è stato associato un dispositivo sorgente via Bluetooth, questo avrà la priorità su tutti gli altri sorgenti collegati
2. AUX
3. Ottica

Nota : Se due dispositivi sorgenti sono collegati rispettivamente su un cavo ottico e un cavo AUX, allora l'ingresso AUX sarà quello che avrà la priorità.

Nel caso si volesse ascoltare l'ingresso ottico, allora bisognerà rimuovere il cavo AUX dallo Humax Soundbar.

+ Impossibile trovare lo Humax Soundbar nella ricerca via Bluetooth

- Controllare che il Bluetooth sia attivo sullo Humax Soundbar
- Controllare che il led del Bluetooth (blu) stia lampeggiando continuamente (se non è ancora stato associato nessun dispositivo) o è fisso quando un dispositivo è correttamente associato e connesso
- Lo Humax Soundbar apparirà come "Humax Blade" nella lista dei dispositivi ricercati
- Se richiesto, il codice PIN di associazione via Bluetooth è 0000
- Se lo Humax Soundbar è già associato al dispositivo sorgente, si prega di rimuoverlo. Provare quindi a riassociare di nuovo

Assistenza e Supporto

Le informazioni riguardanti la risoluzione dei problemi, l'aggiornamento del software e l'assistenza al prodotto sono consultabili sul sito HUMAX. Qualora il prodotto richiedesse un'assistenza in garanzia si prega di contattare il centrod'assistenza tecnica i cui recapiti sono reperibili sul sito HUMAX italia.

HUMAX Italia

-. Sito web: www.humaxdigital.com/italy -. E-mail: servizioclienti@humaxdigital.com

Nota: Per riparazioni hardware, visitare il nostro sito web.

Humax Srl

Via Brescia 28 20063 Cernusco S/N (MI)

Fax. +39 02 99765669

Garanzia Humax

Attenzione, la presente garanzia è valida solamente per il paese in cui è stato acquistato il prodotto. Il cliente per potere fare valere i propri diritti di garanzia si dovrà rivolgere esclusivamente al proprio fornitore oppure all'importatore/distributore del prodotto.

Garanzia

Il costruttore garantisce che questo prodotto sarà privo di difetti di costruzione o materiale in condizioni di uso normale per un periodo di ventiquattro mesi, fatta salva l'osservanza delle istruzioni di utilizzo e manutenzione. La garanzia decorre dalla data di acquisto dell'apparecchi presso il rivenditore.

Condizioni di garanzia

1. Qualora fosse necessario usufruire delle prestazioni di garanzia, siete pregati di rivolgervi al rivenditore, presso il quale avete acquistato l'apparecchio.
2. Per poter usufruire della garanzia, l'utente dovrà presentare la prova di acquisto del prodotto costituita dalla copia della fattura originale oppure dallo scontrino rilasciato dal rivenditore/fornitore o da una relativa conferma. Il numero di serie dell'apparecchio deve essere leggibile.
3. HUMAX o la sua rappresentante a loro insindacabile giudizio si riservano di assolvere i propri obblighi riparando o sostituendo il prodotto, se necessario anche con un prodotto con prestazioni identiche o superiori, oppure sostituendo le parti difettose.
Prestazioni di garanzia, riparazione o sostituzione di singole parti o di componenti non comportano un prolungamento del periodo di garanzia originario.
Dopo la riparazione le parti sostituite permangono direttamente presso HUMAX oppure presso il centro assistenza convenzionato.
Dette parti vengono rese solamente nel caso in cui la relativa richiesta venga inoltrata all'atto dell'affidamento dell'incarico di esecuzione dell'intervento di riparazione.
4. La garanzia è limitata ai difetti di materiale e costruzione. Ciò esclude:
 - a. controlli periodici, tarature, aggiornamenti software, manutenzione o conversione, sostituzione di parti soggette a normale usura;
 - b. danni causati da incidenti, negligenza, modifiche, uso improprio o da una installazione non eseguita a regola d'arte;
 - c. danni causati da fulmini, sovratensioni, liquidi, fuoco, atti di guerra, atti vandalici, messa a terra non corretta/insufficiente o assente, areazione insufficiente oppure da altre cause non imputabili a HUMAX;
 - d. danni causati da interventi di riparazione effettuati da centri di assistenza non autorizzati/persone non autorizzate e/o dall'utilizzo di parti di ricambio non originali;
 - e. prodotti sui quali l'etichetta riportante il numero di serie è stata rimossa o resa illeggibile;
 - f. spese di viaggio e costi derivanti dalla deinstallazione/installazione dell'apparecchio.
5. Spese derivanti da interventi di riparazione in garanzia effettuati da centri di servizio non autorizzati o da persone non autorizzate non vengono rimborsate.
6. Tutte le spese relative ad interventi e richieste alla cui base non vi sia un difetto del prodotto sono a carico dell'utente.
Ciò vale anche per gli oneri legati all'installazione e all'illustrazione delle norme d'uso dell'apparecchio.
7. HUMAX o la sua rappresentante declinano qualsiasi responsabilità legata alla perdita indiretta o conseguente di accessori o di danni causati a quest'ultimi.
8. Le presenti condizioni di garanzia lasciano impregiudicati i diritti previsti a favore del consumatore dalle disposizioni del codice di Consumo (D.Lgs 2006/2005) o da altre disposizioni legislative nazionali.

EU regulatory conformance

Hereby, HUMAX Co., Ltd, declares that this STA1200BSW is in compliance with the essential requirements and other relevant provisions of Directive 1999/5/EC.
The product carries the CE mark applied onto it.



The Declaration of conformity made under EC Directives and is available for viewing at the following location in the EU community:
<http://www.humaxdigital.com/global/support/support.html>

Wireless equipment use information

1. In France
Authorization for outdoor usage is limited to Channels 1~7 (2.400 ~ 2.454 Ghz).
2. In Italy
For outdoor usage a general authorization is required from the national spectrum authorities.
3. In Latvia
For outdoor usage an authorization is required from the Electronic Communications Office.
4. 5GHz Radio Local Area Networks (RLANs) Band only indoor use.

Norme per la sicurezza

Questo prodotto è stato fabbricato in conformità alle norme internazionali di sicurezza.
Si prega di leggere attentamente le seguenti norme di sicurezza.

Istruzioni di sicurezza e precauzioni

1. RETE ELETTRICA

Utilizzare questo prodotto solo con il tipo di alimentazione elettrica indicato sull'etichetta.
Se non siete sicuri del tipo di alimentazione fornito dalla propria abitazione, consultare l'azienda locale.
Scollegare il prodotto dalla rete elettrica prima di iniziare qualsiasi intervento di manutenzione o di installazione.

2. SOVRACCARICO

Non sovraccaricare le prese a muro, prolunghe o adattatori, in quanto ciò potrebbe provocare incendi o scosse elettriche.

3. LIQUIDI

Il prodotto non deve essere esposto a liquidi di alcun tipo. Inoltre, oggetti contenenti liquidi non devono essere posizionati sull'apparecchio.

4. PULIZIA

Scollegare il prodotto dalla presa a muro prima della pulizia.
Usare un panno leggermente umido (senza solventi) per spolverare il prodotto.

5. VENTILAZIONE

Le fessure sulla parte superiore del prodotto devono essere lasciate scoperte per consentire una corretta ventilazione all'interno dell'unità.
Non posizionare il prodotto su tappeti o superfici morbide.
Non impilare apparecchiature elettroniche sulla parte superiore del prodotto.

6. ACCESSORI

Non utilizzare accessori non supportati in quanto potrebbero essere pericolosi o causa di danni sul prodotto.

7. FULMINI, TEMPESTE O INUTILIZZO

Scollegare il prodotto dalla presa a muro durante un temporale o quando viene lasciato inutilizzato per un lungo periodo di tempo.
Questo consentirà di evitare danni dovuti a fulmini o picchi di corrente.

8. OGGETTI ESTRANEI

Non inserire oggetti nelle fessure dell'unità, ossia dove è possibile toccare punti di tensione o che possono causare danni.

9. SOSTITUZIONE DEI COMPONENTI

Quando è necessario una sostituzione dei componenti, assicurarsi che il tecnico utilizzi dei pezzi di ricambio specificati dal fabbricante o che hanno le stesse caratteristiche di quelli originali.
La sostituzione non autorizzata può provocare ulteriori danni all'unità.

Guida all'installazione

Come installare lo Humax Soundbar al muro

Prima di montare lo Humax Soundbar al muro, collegare saldamente tutti i cavi. Fare riferimento alla seguente guida di installazione.

Attenzione!

Quando lo Humax Soundbar è montato al muro, potrebbe essere esposto ai danni.

- Non installare lo Humax Soundbar capovolto
- Non collocare nessun oggetto sullo Humax Soundbar quando è montato sul muro
- Si prega di fissare saldamente lo Humax Soundbar
- Si prega di tenere lontani i bambini dallo Humax Soundbar montato sul muro

Accessori necessari



SOUNDBAR

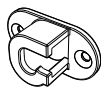

2EA

Supporto per
fissaggio a muro



4EA

Vite-25mm



4EA

Tassello in plastica

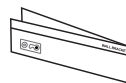

Linea guida per il
fissaggio a muro

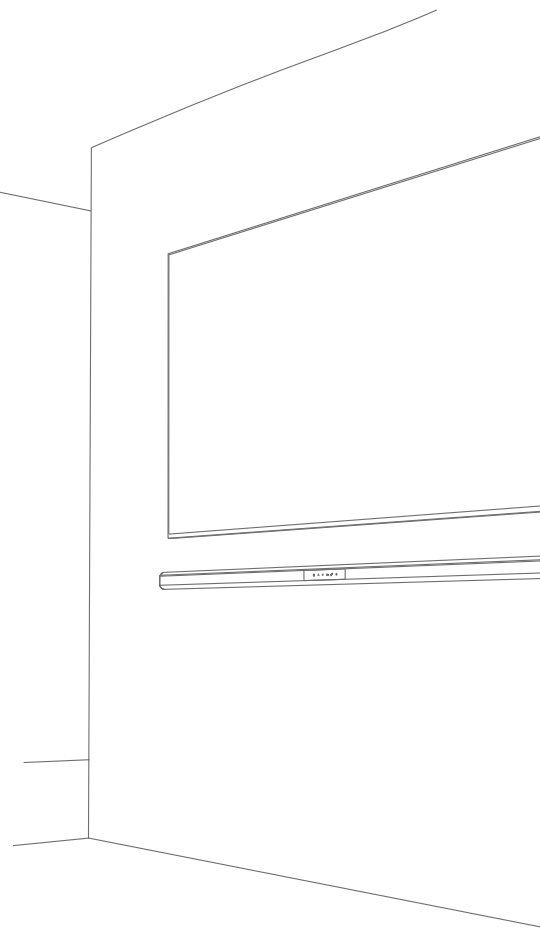

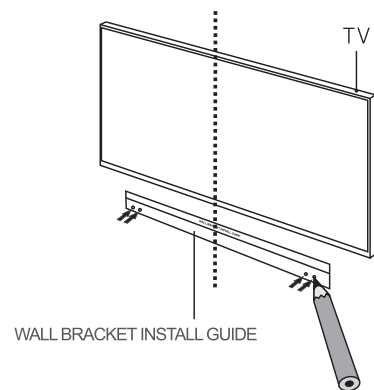

1. Si prega di prendere il foglio guida "WALL BRACKET INSTALL GUIDE" per il fissaggio a muro e collocandolo nella posizione desiderata (come mostrato in figura). Marcare quindi le posizioni delle viti mostrate sul foglio.

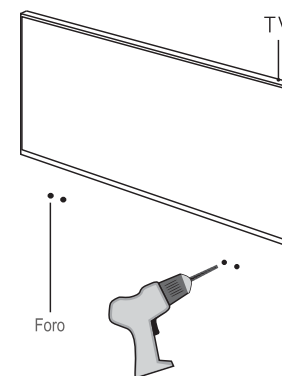

2. Fare i fori sul muro in corrispondenza dei punti marcati utilizzando un trapano.

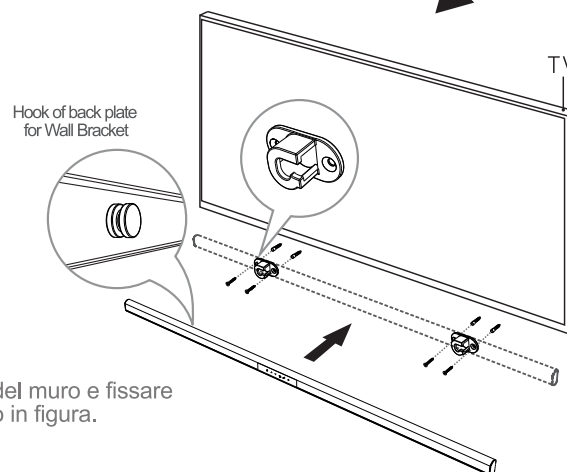

3. Inserire quindi i tasselli di plastica nel fori del muro e fissare i supporti con le relative viti come mostrato in figura.

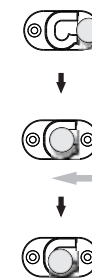

Come agganciare lo Humax Soundbar con il supporto a muro

HUMAX



The product specifications may change without predictions for improvements of performances,
and the image within the manual may be somewhat different from the real product image.

Benutzerhandbuch

STE1000BSW

Schlanke 2.1-Kanal Soundbar
mit Bluetooth



HUMANX

• Willkommen bei HUMAX

Vielen Dank, dass Sie sich für ein Gerät von HUMAX entschieden haben!

Lesen Sie diese Bedienungsanleitung aufmerksam durch, damit eine korrekte Installation, Verwendung und Pflege und somit eine optimale Leistung des Geräts gewährleistet ist. Bewahren Sie diese Bedienungsanleitung zum späteren Nachschlagen in der Nähe des Geräts auf.

Änderungen der in dieser Bedienungsanleitung enthaltenen Informationen vorbehalten.

Allgemeine Informationen

+ HUMAX ist ein eingetragenes Warenzeichen der HUMAX Co. Ltd.

+ Dieses Dokument darf ohne die vorherige schriftliche Zustimmung von HUMAX weder ganz noch auszugsweise vervielfältigt, übersetzt oder anderweitig verwendet werden, es sei denn, der Inhaber der Urheberrechte willigt ein oder die Urheberrechtsgesetze lassen dies zu.

+ Dieses Handbuch ist gemäß der Spezifikation des gegenwärtigen Produkts erstellt worden. Einzelne Beispieltex-te, -tabellen, -bilder, ausführliche Funktionen des Produkts bzw. Hardware & Software Spezifikationen können ohne extra vorherige Ankündigung geändert werden.

Gerät gemäss CLASS-B (Sende-Kommunikationsgerät für Hausbetrieb)

Dieses Produkt ist ein registriertes Gerät das elektromagnetische Wellen emittiert, und ist vor allem für den häuslichen Einsatz konzipiert. Man kann es in allen Räumen benutzen. Dieses drahtlose Gerät kann eventuell Überlagerungen der elektrischen Wellen erzeugen. Es entsteht dabei jedoch keinerlei Gefährdung für Ihre Gesundheit.

1. Produktbezeichnung(Modellbezeichnung): STE1000BSW

2. Datiert: siehe Gerätegehäuse

3. Firma der Qualitätssicherung: HUMAX Co. Ltd.

4. Hersteller/Ort: HUMAX Co.Ltd. /Republik of Korea

- **Umfang des mitgelieferten Zubehörs**



STE1000BSW



1. Ständer



2. Fernsteuerung

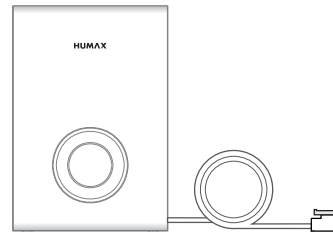

3. Tieftonlautsprecher



4. Benutzerhandbuch

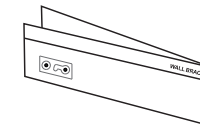

5. Zubehör für Wandmontage

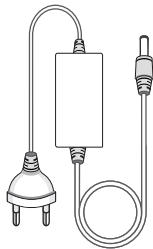

6. Strom - Netzteil

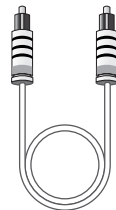

7. Optisches Kabel

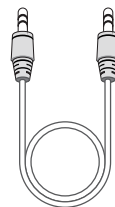

8. AUX Kabel

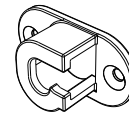

2EA



4EA



4EA

9. Wandhalterung 10. Schraube-25mm(H)

11. Kunststoffdübel

*Beim Auspacken des Gerätes prüfen Sie bitte die Vollständigkeit des beigeackten Zubehörs.

- Namen und Funktionen einzelner Teile

STE1000BSW

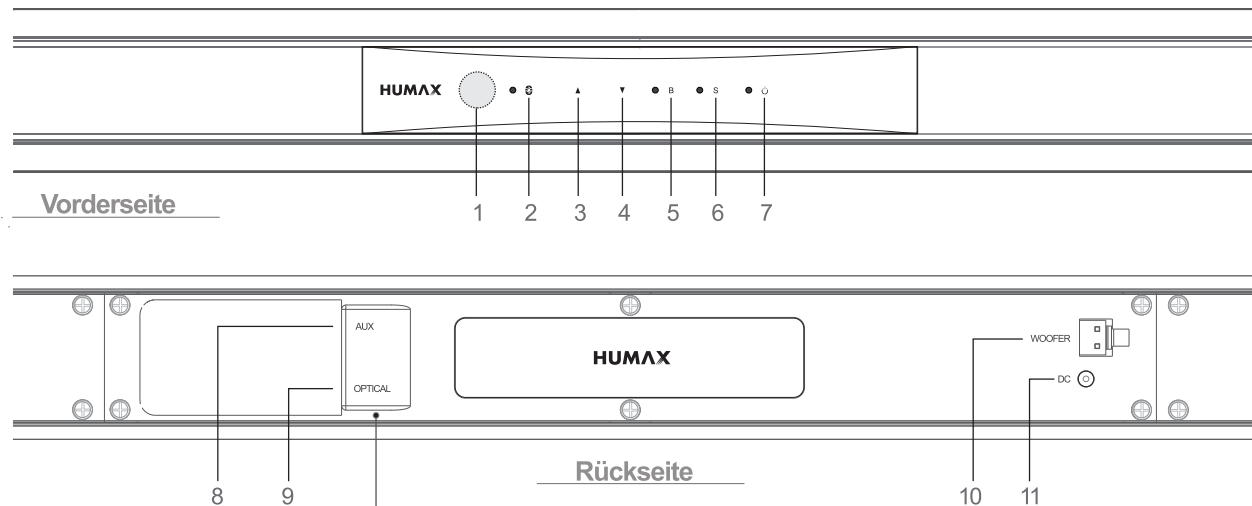

- | | |
|--|--------------------------------------|
| 1. Empfangskontrolleuchte für Fernbedienungssignal | 6. Surround für Fernbedienungssignal |
| 2. Pairing-Modus für Bluetooth | 7. EIN – AUS |
| 3. Lauter | 8. AUX Eingang |
| 4. Leiser | 9. Optischer Eingang |
| 5. Bass | 10. Subwoofer Ausgang |
| | 11. Netzteilanschluss |
| | 12. Stummschalter |

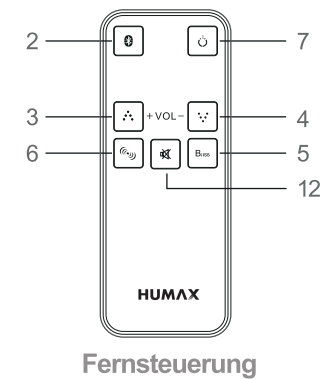

Fernsteuerung

• Anschlussweise

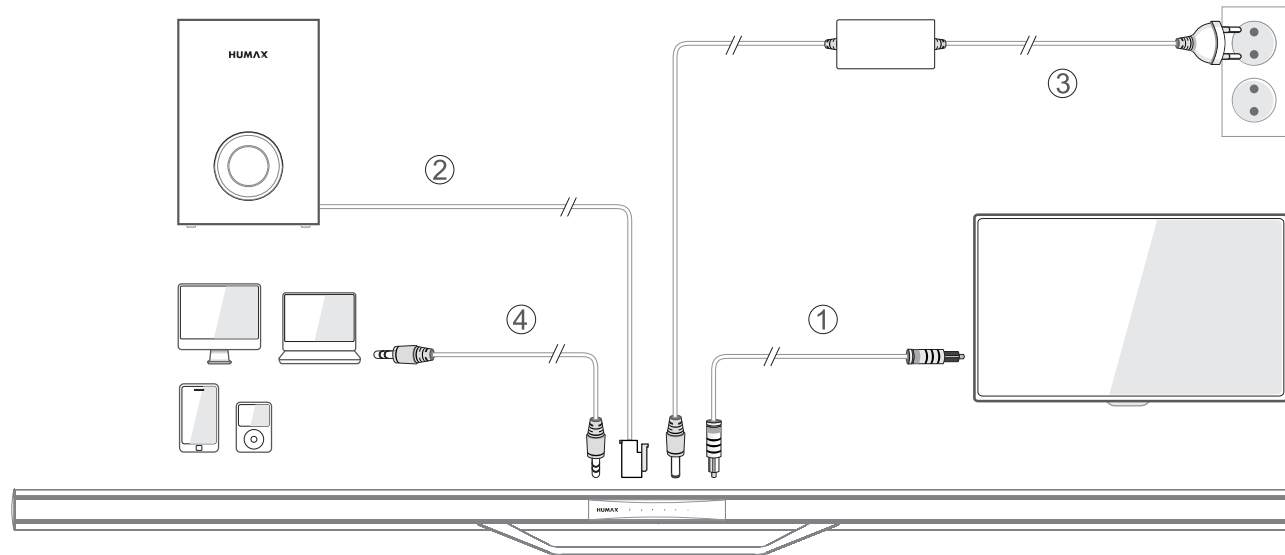

- ① Receiver- oder TV-Anschluss : Verbinden Sie den optischen Ausgang (SPDIF) am TV-Gerät oder am Receiver unter Verwendung des mitgelieferten Lichtwellenleiters (optisches Kabel) mit dem optischen Eingang an der Soundbar
- ② Subwoofer-Anschluss: Stecken Sie den Subwoofer Stecker in den Subwoofer Ausgang ein.
- ③ Stromanschluss: Verbinden Sie das Strom-Netzteil auf der Rückseite des Soundbar-Lautsprechers mit dem DC-Anschluss
- ④ AUX-Anschluss: Schließen Sie den AUX-Klinkenstecker auf der Rückseite des Soundbar-Lautsprechers an den AUX-Ausgang des Audiozuspielgeräts (z.B. Kopfhörerausgang des Smartphones oder PCs)

* Warnhinweis: Stellen Sie Verbindungen mit dem Soundbar- oder dem Subwoofer-Lautsprecher nur im ausgeschalteten Zustand her.
Schalten Sie das Gerät erst danach ein!

- **LED-Anzeigen**

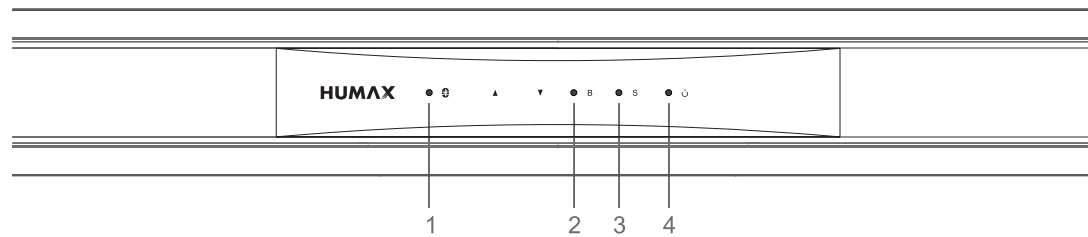

LED Farbe	Art	Funktion
1. Blau	Blinkt	Bluetooth Pairing-Modus
Blau	Ein	Bluetooth Betrieb
2. Grün	Ein	Bass Verstärkung
3. Orange	Ein	Surround-Modus
4. Rot	Ein	Strom an
Rot	Blinkt	Lautstärke auf, ab
Rot	Blinkt ohne Unterbrechung	Stummschaltung

- **Bluetooth Anschlussweise**

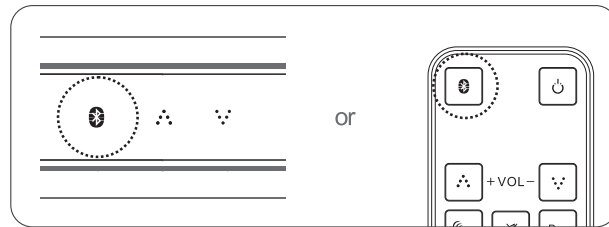

Drücken Sie die **BLUETOOTH** Taste um den **Pairing-Modus** einzuschalten. Die blaue Bluetooth-Kontrolleuchte beginnt zu blinken.

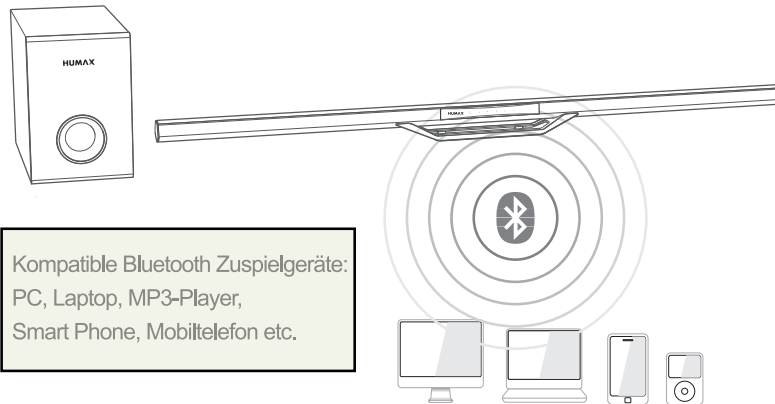

Kompatible Bluetooth Zuspelgeräte:
PC, Laptop, MP3-Player,
Smart Phone, Mobiltelefon etc.

Mit **STE1000BSW** können Sie verschiedene Musik frei genießen.

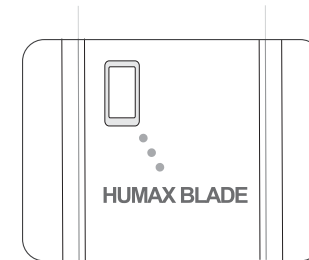

Versetzen Sie Ihr Bluetooth Zuspelgerät in den Bluetooth-Suchmodus. Sie finden die Soundbar "**HUMAN BLADE**".

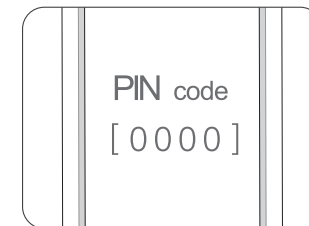

Paaren Sie Ihr Zuspelgerät und die **HUMAN BLADE** durch Eingabe des PIN-Codes: **0000**.

- **Spezifikation des Produkts**

	STE1000BSW
Impedanz	8 ohm
Lautdruck	90dB ± 3dB
Lautsprecher System	160W(Front 60W x Sub Woofer 100W)
Toneffekt	Bass Booster / Surround
Anschluss	Drahtlos: Bluetooth 3.0+EDR/kabelgebunden: optisches Kabel, AUX Kabel
In-put	Optisches Kabel (1) / AUX (1) / Stromanschluss (DC)
Out-put	AV Klinke(1) zu Tieftonlautsprecher DC 18V 3.0A
Zwischenstecker Input	100 - 240V ~50/60Hz
Zwischenstecker Output	DC 18V 3.0A
Größe	Vorderseite: 1000(B)×44(H)×20(T)mm/Tieftonlautsprecher: 195(W)×266(H)×265(D)mm
Fernsteuerung	○
Farbe	● Schwarz
Umgebungs Betriebstemperatur	-20° to 40° C

• Warnhinweise beim Benutzen des Produkts

WARNHINWEISE zur Benutzung:

Bitte lesen Sie diese Hinweise vor der Benutzung des Gerätes.

Jede Haftung / Gewährleistung des Herstellers / Inverkehrbringers ist bei unsachgemäßer Benutzung ausgeschlossen.

1. Benutzen Sie die Soundbar zu keinem anderen Zweck als dem im Handbuch beschriebenen.
2. Bei unsachgemäßem Eingriff erlischt jede Garantieleistung.
3. Setzen Sie die Soundbar keinen großen Erschütterungen aus !
4. Setzen Sie das Gerät keiner Feuchtigkeit aus und betreiben Sie die Soundbar nur in trockenen Räumen.
5. Vermeiden Sie es, die Soundbar hoher statischer Elektrizität auszusetzen.
6. Vermeiden Sie starke Magnetfelder wie diese z.B. bei Lautsprechermagneten auftreten.

* Sie sollten eine Steckdose in unmittelbarer Nähe zum Gerät nutzen und diese leicht zugänglich machen.

Garantie Garantiekarte

WICHTIG:

Bewahren Sie diese Karte zusammen mit der Original-Rechnung oder dem Kaufbeleg an einem sicheren Ort auf, und legen Sie sie bei einer Reparatur im Rahmen der Garantie auf Anfrage bei Ihrem Händler oder dem Geschäft vor, in dem Sie das Gerät erworben haben.

• **Modellnr.:** _____

• **Seriennr.:** _____

• **Kaufdatum:** _____

• **Unterschrift des Händlers:** _____

• **Unterschrift des Käufers:** _____

HUMAX bedankt sich für den Kauf dieses HUMAX-Geräts.

Wir empfehlen Ihnen, auf dieser Karte die Seriennummer, die Sie am Gerät ablesen können, und sonstige Kaufinformationen zu notieren und die Karte zusammen mit dem Kaufbeleg in Ihrem persönlichen Unterlagen aufzubewahren. Auf diese Weise können wir Ihnen einen auf Ihre Bedürfnisse abgestimmten Service bieten.

■ GARANTIEBEDINGUNGEN

Bewahren Sie diese Karte zusammen mit der Original-Rechnung oder dem Kaufbeleg an einem sicheren Ort auf, und legen Sie es bei einer Reparatur im Rahmen der Garantie auf Anfrage bei Ihrem Händler oder dem Geschäft vor, in dem Sie das Gerät erworben haben.

■ HUMAX-VERBRAUCHERGARANTIE

HUMAX garantiert vorbehaltlich der umseitig festgelegten Bedingungen, dass dieses Gerät frei von Material- und Verarbeitungsfehlern ist.

■ BEDINGUNGEN

1. Die HUMAX-Garantie gilt für einen Zeitraum von zwei Jahren ab dem Datum des Ersterwerbs.
2. Wenn dieses Gerät innerhalb der Garantiedauer Funktionsstörungen aufweist, wird es vom Händler oder Vertriebspartner wieder in einen für die vorgesehenen Zwecke betriebsfähigen Zustand gebracht, ohne dass Kosten für Personal oder Material geltend gemacht werden.
3. Diese Garantie gilt nur dann, wenn die Garantiekarte vom Käufer ordnungsgemäß ausgefüllt und dem Händler zusammen mit der Originalrechnung oder dem Kaufbeleg vorgelegt wird.
4. Diese Garantie deckt keine Versand- oder Transportkosten für der Versand an uns ab.
5. Die Haftung des Vertriebspartners ist auf die Reparatur defekter Bauteile beschränkt. Die Kosten und Risiken für den Ausbau, den Transport zum Händler und die erneute Installation des Geräts sowie alle sonstigen Kosten, die direkt oder indirekt mit der Reparatur verbunden sind, fallen nicht unter diese Garantie.
6. Die Kosten für Reparaturen im Rahmen der Garantie, die von nicht autorisierten Werkstätten durchgeführt werden, können nicht erstattet werden, und die Garantie erlischt, wenn im Zuge dieser Reparatur Schäden am Gerät entstehen.
7. Diese Garantie deckt ausschließlich Material- und Verarbeitungsfehler ab und umfasst insbesondere nicht das Folgende:
 - a. regelmäßige Überprüfung, Anpassung, Wartung oder Umrüstung sowie der Austausch von Bauteilen aufgrund von normalem Verschleiß;
 - b. Schäden aufgrund von Unfällen, Fahrlässigkeit, Modifizierungen, Einsatz von anderen als HUMAX-Originalersatzteilen, unsachgemäße Verwendung, Installation oder Verpackung;
 - c. Schäden aufgrund von Blitzeinschlag, Überschwemmung, Brand, Krieg, Unruhen, falschen Netzspannungen, nicht ordnungsgemäßer Belüftung oder sonstigen Ursachen, die sich der Kontrolle des Vertriebspartners entziehen;
 - d. Produkte, bei denen der Aufkleber mit der Seriennummer entfernt oder unkenntlich bzw. unleserlich gemacht wurde.
8. Diese Garantie gilt für alle Personen, die innerhalb der Garantiedauer rechtmäßig in den Besitz dieses Geräts gelangt sind.
9. Die Haftung von HUMAX ist auf den von Ihnen tatsächlich gezahlten Kaufpreis für dieses Gerät begrenzt. HUMAX haftet in keinem Fall für zufällige, Sonder-, Folge- oder Nebenschäden.

HUMAX Call Center

Tel: 01806-778870
(20 Cent/Anruf aus dem dt. Festnetz / max. 60 Cent/Anruf aus Mobilfunknetzen)

Öffnungszeiten: Mo-Sa 8:00-20:00 Uhr

E-mail: techinfo@humax-digital.de

Website: www.humax-digital.de

Sprache: Deutsch/Englisch/Türkisch

EU regulatory conformance

Hereby, HUMAX Co., Ltd, declares that this STE1000BSW is in compliance with the essential requirements and other relevant provisions of Directive 1999/5/EC.
The product carries the CE mark applied onto it.



The Declaration of conformity made under EC Directives and is available for viewing at the following location in the EU community:
<http://www.humaxdigital.com/global/support/support.html>

Wireless equipment use information

1. In France
Authorization for outdoor usage is limited to Channels 1~7 (2.400 ~ 2.454 Ghz).
2. In Italy
For outdoor usage a general authorization is required from the national spectrum authorities.
3. In Latvia
For outdoor usage an authorization is required from the Electronic Communications Office.
4. 5GHz Radio Local Area Networks (RLANs) Band only indoor use.

Soundbar Installationsanleitung

Installation mit Soundbar Wandhalterung

Verbinden Sie zuerst alle Kabel und Anschlüsse und montieren Sie die Wandhalterung danach. Prüfen Sie den Inhalt auf Vollständigkeit wie auf den ersten Seiten abgebildet.

Warnhinweise bei der Montage

Wenn Sie das Produkt mit Wandhalterung installieren wollen, beachten Sie bitte folgende Punkte, da es sonst zu Beschädigungen der Soundbar kommen könnte.

- Installieren Sie das Produkt nicht seitenverkehrt
- Verwenden Sie kein anderes als das mitgelieferte Installationsmaterial
- Fixieren Sie die Soundbar möglichst bei der Montage, damit sie Ihnen nicht herunterfällt.

Nötige Zubehörteile für die Installation



SOUNDBAR

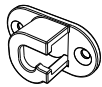

2EA

Wandhalterung



4EA

Schraube-25mm(H)



4EA

Kunststoffdübel

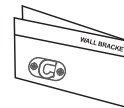

Wandhalterung-Installationszubehör

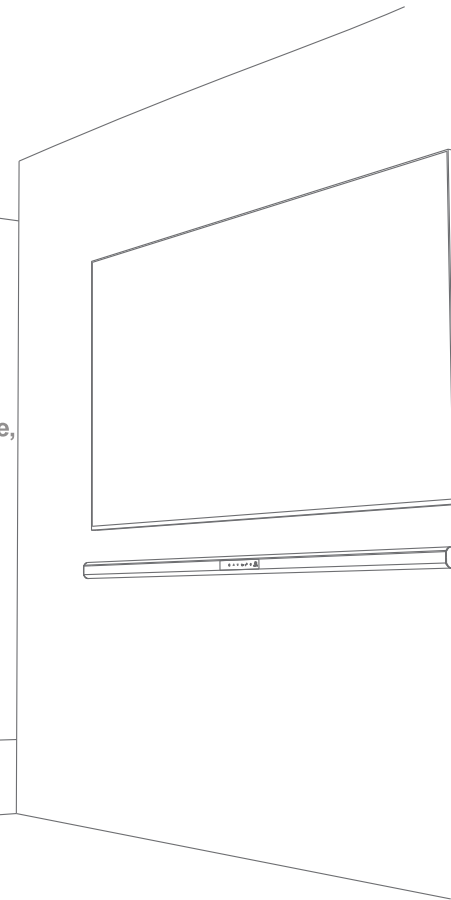

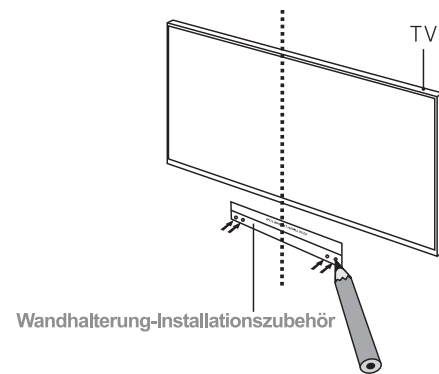

1. Bringen Sie die Soundbar mit einer Wasserwaage in die Horizontale. Verwenden Sie bitte das mitgelieferte Zubehör.

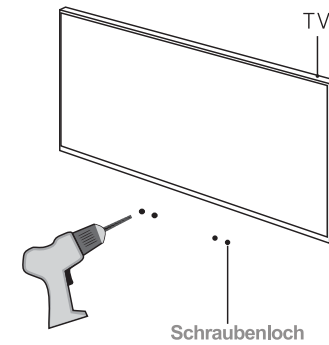

2. Bohren Sie mit einer Bohrmaschine die Löcher an den markierten Stellen.

Haken auf der Rückseite der Soundbar

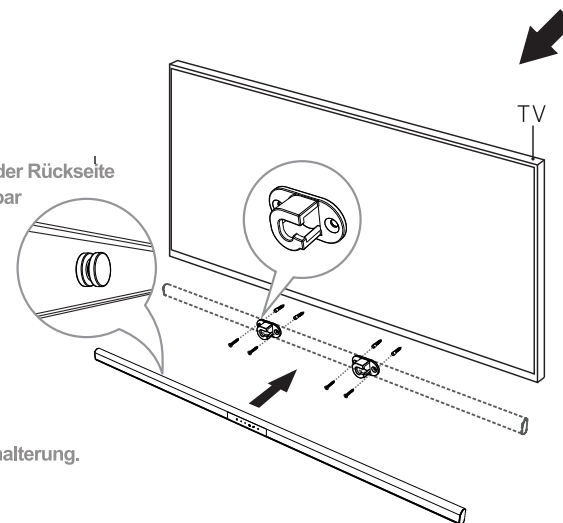

3. Setzen Sie die Soundbar mit Hilfe der Verbindungsstücke in die Wandhalterung.

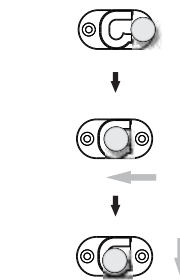

Einhaken der Soundbar an die Wandhalterung

●

This image shows a single sheet of white paper with horizontal ruling lines. The lines are evenly spaced and run across the width of the page. There are no margins, text, or other markings on the paper.

HUMAX



Die Spezifikation des Produkts kann ohne vorherige Ankündigung geändert werden.
Es können leichte Unterschiede zwischen Abbildungen in diesem Benutzerhandbuch und dem tatsächlichen Produkt bestehen.